

SOUTH GAULISH *SIGILLATA* IN SOUTHWEST *HISPANIA* CIRCULATION AND CONSUMPTION

CATARINA VIEGAS
MACARENA BUSTAMANTE-ÁLVAREZ
(eds.)



SOUTH GAULISH *SIGILLATA* IN SOUTHWEST *HISPANIA*

CIRCULATION AND CONSUMPTION

CATARINA VIEGAS
MACARENA BUSTAMANTE-ÁLVAREZ
(eds.)

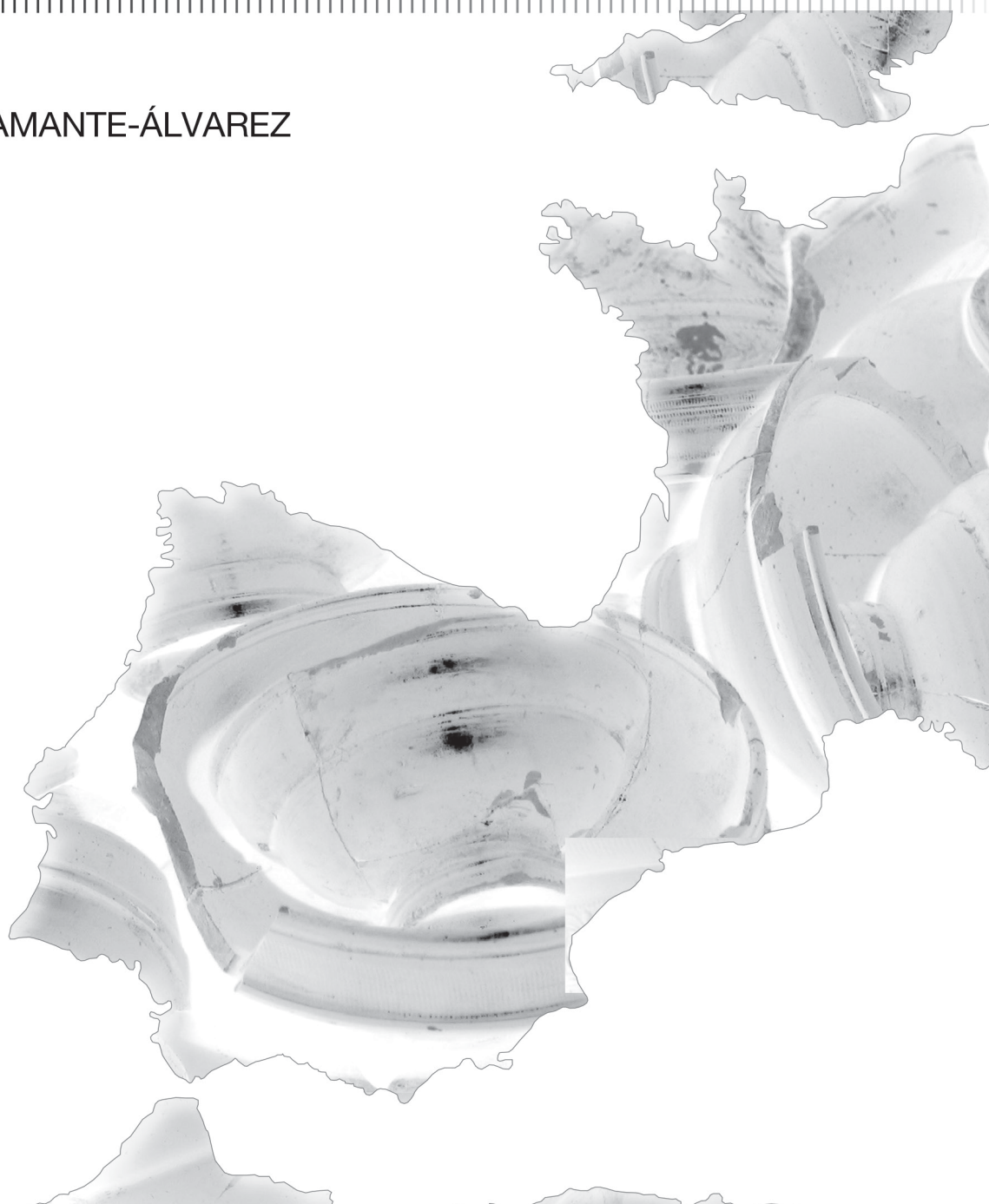



Estudos & Memórias

UNIARQ series

(Centre for Archaeology, University of Lisbon)

Series coordination: Ana Catarina Sousa
Founded by Victor S. Gonçalves

18.

VIEGAS, C.; BUSTAMANTE-ÁLVAREZ, M. (eds.) (2021) –
South Gaulish sigillata in Southwest Hispania: circulation and consumption.
Estudos & Memórias 18. Lisboa: UNIARQ/FL-UL. 244 pp.

Cover: Catarina Viegas and Rui Roberto de Almeida.

Photograph of the cover: South Gaulish *sigillata* from the Guadiaro's wreck,
by Macarena Bustamante-Álvarez.

Typesetting and layout: Rui Roberto de Almeida

Printed and bound by Sersilito – empresa gráfica, Lda.
300 copies

ISBN: 978-989-53453-4-2 / Depósito legal: 000000000000
DOI: <https://doi.org/10.51427/10451/50262>

Copyright © 2021 the authors.
Any reproduction of text and images is prohibited, without the express
authorization of the author, under the terms of the current law,
namely DL 63/85, of March 14, with subsequent amendments.

Lisboa, 2021

This work was financed by Portuguese funds through FCT - Fundação para a Ciência e a Tecnologia in the framework of the projects UIDB/00698/2020 and UIDP/00698/2020.

This book was also financed by the following projects:
'Corpus Vasorum Hispanorum. Análisis tipológico, cronológico y prosopográfico de los sigilla en terra sigillata hispánica a partir de los centros consumidores. Parte I: Lusitania' (PGC2018-093478-A-I00) financed by Convocatoria Proyectos de Excelencia – Plan Estatal de Generación de Conocimiento – Ministerio de Ciencia, Innovación y Universidades – España. And by the Project 'Aplicación de nuevas tecnologías para el desarrollo del Corpus Vasorum Hispanorum. Una herramienta para análisis tipológico, cronológico y prosopográfico de los sigilla en Terra Sigillata Hispánica' financed by Fundación BBVA in the context of the Program Logos Ayuda a la Investigación en Estudios Clásicos 2019.

CONTENTS

<i>Prologue. Overview on the study of terra sigillata in Portugal</i> CARLOS FABIÃO	5
<i>Foreword OF THE EDITORS</i> CATARINA VIEGAS, MACARENA BUSTAMANTE-ÁLVAREZ	13
<i>The Mainz internet database of Names on Terra Sigillata (samian ware), Portugal and Spain and the collaborative samian research network</i> GEOFFREY B. DANNELL, ALLARD W. MEES	17
<i>South gaulish terra sigillata found in Bracara Augusta (North Portugal)</i> RUI MORAIS	27
<i>South Gaulish terra sigillata in the forum of Aeminium (Coimbra, Portugal): a decisive component of the dating process</i> PEDRO C. CARVALHO, RICARDO COSTEIRA DA SILVA	47
<i>South Gaulish terra sigillata in Ammaia (São Salvador de Aramenha, Marvão): typological and stratigraphical analysis</i> JOSÉ CARLOS QUARESMA	57
<i>Potters and vessels: consumers, markets and dynamics at play in the circulation of Gaulish terra sigillata: the evidence for the region under the influence of Olisipo (Lisbon)</i> RODRIGO BANHA DA SILVA	75
<i>Gaulish terra sigillata trade in Augusta Emerita (Mérida). Data from the sigilla in the Museo Nacional de Arte Romano (MNAR)</i> MACARENA BUSTAMANTE-ÁLVAREZ, JOSÉ M. JEREZ LINDE	93
<i>Preliminary results on the Gaulish terra sigillata from the fish-salting production centre at Tróia</i> ANA PATRÍCIA MAGALHÃES, INÊS VAZ PINTO, PATRÍCIA BRUM	117
<i>The circulation of South Gaulish sigillata in southern Lusitania: Alentejo region and the Algarve (Portugal)</i> CATARINA VIEGAS, CAROLINA GRILO, CATARINA ALVES	131
<i>The Gaulish terra sigillata in Baelo Claudia. Analysis of the contexts from the 'Puerta de Carteia'</i> MACARENA BUSTAMANTE-ÁLVAREZ, DARIO BERNAL-CASASOLA, ALICIA ARÉVALO GONZÁLEZ	151
<i>Gaulish terra sigillata in Seville. New data, new perspectives</i> ELISE ARNOLD, ENRIQUE GARCÍA VARGAS	177
<i>First approach on the distribution of amphorae from Gaul in Lusitania</i> RUI ROBERTO DE ALMEIDA, VITOR FILIPE	211

THE GAULISH TERRA SIGILLATA IN BAELO CLAUDIA. ANALYSIS OF THE CONTEXTS FROM THE 'PUERTA DE CARTEIA'

Macarena Bustamante-Álvarez

mbustamante@ugr.es
Universidad de Granada

Darío Bernal-Casasola

dario.bernal@uca.es
Universidad de Cádiz

Alicia Arévalo González

alicia.arevalo@uca.es
Universidad de Cádiz

Abstract

A contextualized study of the *sigillata* from an excavation at the so-called East or *Carteia* Gate in *Baelo Claudia* is presented. This work revealed the transformation that this area of the city underwent from the Julio-Claudian era to the 6th century AD. Construction debris, rubbish dumps, as well as material from a funerary context all contribute to compose a very complete image of how the commercial pattern of consumption of fine wares appears in this important settlement: and so reveals more of the dynamics of trade in the Straits of Gibraltar.

Resumen

Se presenta un estudio contextualizado de las *sigillatas* localizadas en una intervención en la denominada Puerta Este o de *Carteia* en *Baelo Claudia*. Esta excavación permitió conocer la fisonomía de este punto de la ciudad desde época julio-claudia hasta el siglo VI d.C. Se alternan contextos constructivos, de vertido así como de necrópolis que aportan una visión muy completa de cómo fue la pauta de consumo de este tipo de vajilla fina en un enclave de vital importancia para conocer la dinámica comercial del Círculo del Estrecho.

Keywords

Baelo Claudia; *sigillata*; Gate of *Carteia*; dump; necropolis.

Palavras-chave

Baelo Claudia; *sigillata*; Puerta de *Carteia*; basurero; necrópolis.

*Belo, important marché espagnol
de la céramique de la Graufesenque*

Sillières 1977

1. Introduction

Baelo Claudia is one of the most studied Hispanic sites with reference to the commercial dynamics of Gaulish *terra sigillata* in *Hispania* (Fig. 1). Plentiful studies have convincingly asserted that this place forms a crucial reference point in any number of ceramic investigations. The publications of Sillières (1977), Bourgeois and Mayet (1989) or, more recently, Bustamante (2010) offer wide overviews of the tableware consumed here. However, these studies, mostly, have had to face the problem of analyzing decontextualized pieces or, at least, without precise information of the contexts where they were recovered.

Faced with this problem and utilizing material found by the University of Cádiz in 2005 at that section of the eastern wall coinciding with the *Puerta de Carteia* (more information about this work may be seen in Arévalo et al., 2006 and 2016), we have decided to take this opportunity to examine the Gaulish *sigillata* in relation to the other groups of fine tableware located here, analyzing them by their contexts.

This examination will allow us to observe the patterns of consumption of the tableware in the city within a very precise chronological frame, concentrating on the first two centuries of the Christian era.

The main objective of this study, then, is to observe over time, and so comprehend, the commercial activity in this Baetican city, based on the fine tableware consumed. The value of this study is in the nature of the findspot, a huge dumping ground at the gates of the city – running from the beginning of the Julio-Claudian dynasty until the 6th century AD (Bernal *et al.*, 2011). The analysis is anchored in the stratigraphy that, without question, grants us a new level of precision in investigating the fine tableware, in time and for its source of origin.



Fig. 1 – Location of *Baelo Claudia* in the Iberian Peninsula.

Group	MNI	Percentage in this study	Percentage in other publications (Bourgeois and Mayet, 1991: 383)
Campanian black-gloss A	1	0,084	-
Italic terra sigillata	113	9,5	6,90
Gaulish terra sigillata	816	68,6	24,34
Peñaflor-type sigillata	44	3,7	-
Hispanic terra sigillata	151	12,7	10,53
ARSW-A	25	2,1	21,90
ARSW-C	5	0,42	8,91
ARSW-D	31	2,6	25,15
Claire B	1	0,084	-
Luisante	1	0,084	0,81
Phocaeen red slip ware	1	0,084	1,31
Orange DSP	1	0,084	-

Table 1 – Quantity of pottery fragments: studied pieces comparing with previous publications.

The analysis involves a total of 1190 MNI (=Minimum Number of Individuals): it is divided by percentage and quantitatively into ceramic groups as explained (**Table 1**).

Although dealing with a wide stratigraphy as mentioned above, even the briefest of glances reveals an impression of the process of soil deposition that took place, focusing on the second and third quarters of 1st century AD. Placing the data in the diagram in chronological order – i.e. from the earliest to the latest products, the quantitatively most important concentration occurs at this early period. The ceramics consumed at that time reached 96,6% (Italic *terra sigillata*, Gaulish *terra sigillata*, Peñafior, Hispanic *terra sigillata* and ARSW-A) (**Fig. 2**).

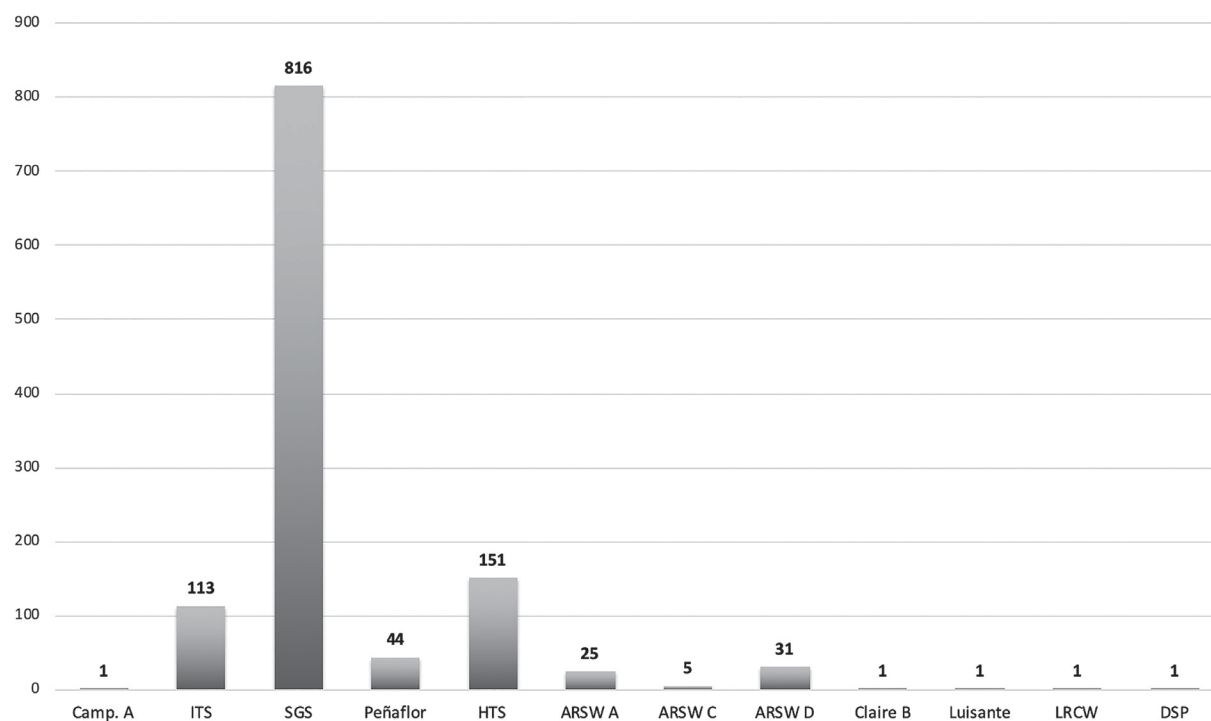

Fig. 2 – Quantitative graph of the groups of pottery identified.

Concerning the ceramics, this study addresses matters such as:

- Establishing the beginning of the arrival of the imported products.
- Defining the main forms consumed and the possible existence of a typical 'table service' in the area.
- Assessing the causes behind both a disproportionate presence and/or absence of some ceramic groups.
- Comparing the dynamics of consumption with respect to the adjacent Coast of the Strait of Gibraltar and any possible implications emerging on the management of the South Iberian trade.

This study also raises some questions related to the historical-chronological nature of the area excavated: the chronology of the construction and subsequent repair of the eastern wall, the dating for the start and end of the dumping, as well as that for the change in purpose when it served as a necropolis in Late Roman period.

2. The contexts of the Julio-Claudian dynasty

The deepest levels of the dump allowed investigation into the construction of the eastern wall. Traditionally, its chronology had been tied to the time of Augustus (Bernal *et al.*, 2011: 74). The context here explored indeed placed this construction in the Late-Augustan years. The stratigraphical units involved presented but a little material, but significant enough to provide chronological precision.

In these contexts, 21 pieces of fine tableware were recovered: 57,14% correspond to Italic *sigillata*, 33,33% to Gaulish and 9,52% to Peñaflor-type ceramics. These percentages look normal enough if we take into account the general dynamics of the *Círculo del Estrecho*, where the Italic *sigillata* dominates the Southern market until the reign of Claudius (Bustamante, 2010: 160), at which time the Gaulish *sigillata* monopolizes the entire market.

The key to dating this moment are the Italic *sigillata* present in several forms. There is a predominance of cups and a lack of plates, a pattern also repeated with the Gaulish *sigillata*. The Italic pieces come from two workshops that compete for the dominance in the general area: Pisa and Arezzo. In these first moments, the predominance of Arezzo is detected, but as time goes by, Pisa takes control of the Baetican coastal area in the Straits of Gibraltar region.

The main identified pieces are single examples of Consp. 12.2., 18.1. (**Fig. 3, 2**), Consp. 20 (**Fig. 3, 4**), Consp. 23, 31.1, 32.1, 32.2, 50.3.1 (**Fig. 3, 12**), R. 3.1. (**Fig. 3, 10 and 13**), as well as some indeterminate forms. As we can see, the latest chronological limit of these pieces is AD 30. All these examples located in this context are widely represented in *Baelo Claudia*, as is concluded too in other studies (Bustamante, 2010: 159).

The second most well represented group of origin would be that of the Gaulish *sigillata*. The predominance of pieces from La Graufesenque is clear; in fact, in this study only one specimen of a different provenance has been located, specifically from Montans. Although the pieces are few in number, they do represent very clearly the situation existing just as this production is starting to take off. First, the predominance of the cups (Drag 24/25, **Fig. 3, 11** and Drag. 27, **Fig. 3, 5**), being Drag. 24/25 more numerous. These pieces would form a table service, along with plates, possibly Drag. 18 (**Fig. 3, 3 and 7**). The form Drag. 27a attested is in the van at this peak moment of consumption, being the piece that most widely appears in the *Baelo* record throughout the 1st century AD. A Drag. 15/17 in its earliest variant also appears (**Fig. 3, 1**), as well as some Ritt. 9 (**Fig. 3, 6 and 8**). Fragmented specimens difficult to assign were also located (**Fig. 3, 9**). Concerning the stamps, the following have been identified (**Table 2**):

Form	Reading	Potter (Samian Research Database)
Ritt. 9	COP	<i>Copio?</i> (1 d.C.)
Drag. 27	RV truncated	-
Drag. 27	(.)VIII	-
Ritt. 9 (Fig. 3, 8)	VI(.)	-
-	[.]MON	-
-	SENOMA[.]	<i>Senomant</i> (AD 30-60?)

Table 2 – Gaulish stamps identified in the first phase.

Peñaflor-type ceramics appear at a very low rate. The two examples known clearly reflect the table service consumed in southern Iberia: namely that consisting of the Martínez I/Celti 14/imitation of Consp. 8.3 and the Martínez II/Consp. 2.1. Chronologically, we can be sure that this form is typical of the first Julio-Claudian moments. Moreover, its absence in the Tiberian contexts, as is the case of the

necropolis of Constanca (Córdoba), reveals its very short lifespan (Vaquerizo, Garriguet and Vargas, 2005). The identification of these forms in the deposit B of Capote (Zarzalejos, 2003: 134-135, Fig. 30, n° 495-497) further points to this reign as a key date.

In these initial moments, although only a few examples are available, it is very clear we are observing the beginning of the Early Imperial commercial circuit. Thus, the dominance of Italian *sigillata* (57,14%) and the beginning of the Gaulish (33,33%) are the predominant points to note. Hispanic production is underrepresented, with just some pieces of Peñaflor-type ceramics (9,52%). There is no sign of any products in Hispanic *sigillata*, such as the first generation material of the Andújar potters.

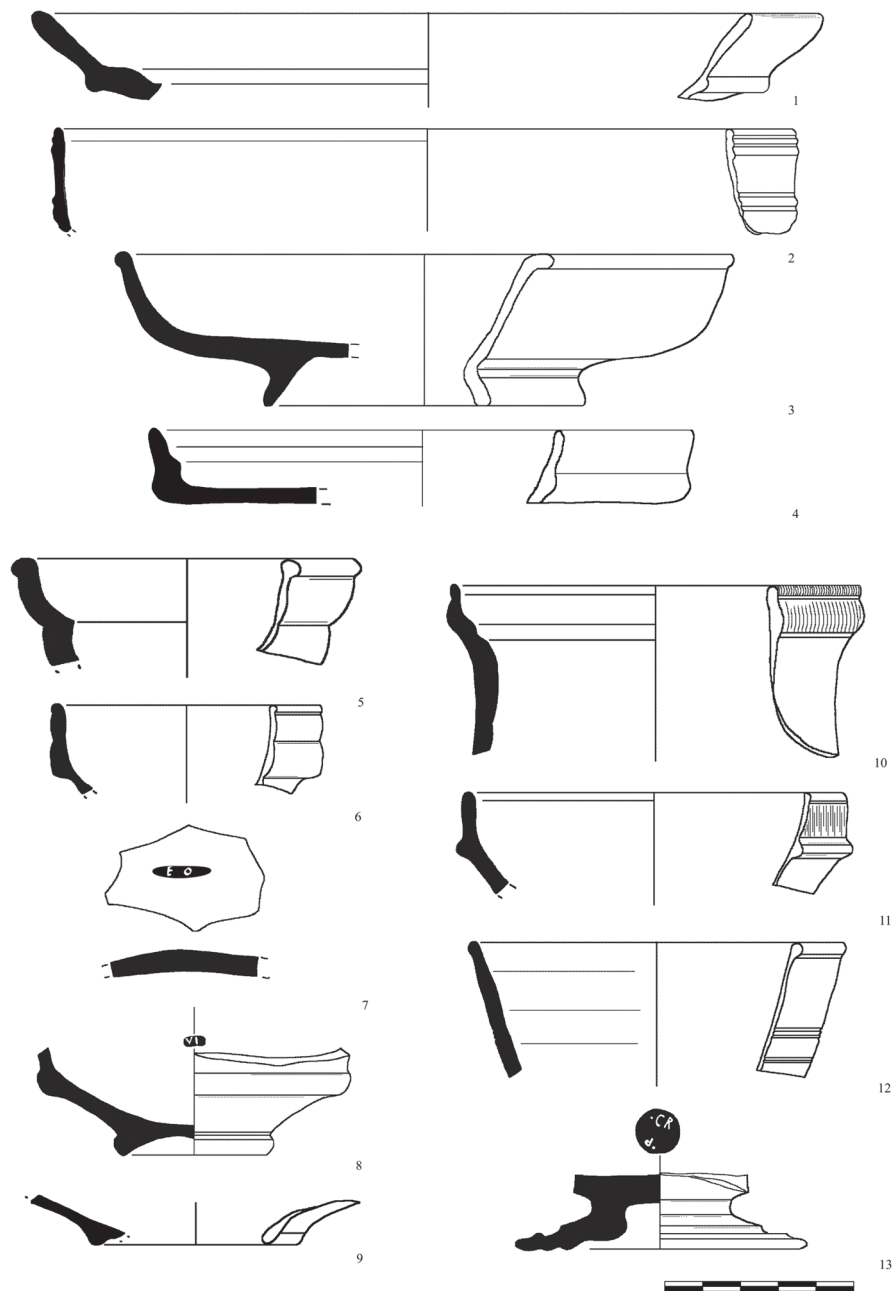

Fig. 3 – Context from the Augustan period. Drag. 15/17 and 18 (1, 3 and 7), Drag. 27 (5), Ritt. 9 (6 and 8), indeterminate (9) and Drag. 24/25 (11), Consp. 18.1 (2), Consp. 20 (4), variant R. 3.1. (10), possible R.3.1. (13) and cup of the Consp. 50. 3.1 (12).

2.1. Ceramic evidence of a possible traumatic event from the time of Claudius

In the middle of the 1st century, more specifically between the years AD 40-60, an earthquake has been recorded archaeologically (Silva *et al.*, 2005), an event that changed the appearance of the city. In the studied contexts, a series of strata, associated with structural repairs to the wall, are included: by the details of their nature, said strata can be dated to between the years AD 25-50. They may reflect the after-effects of this natural catastrophe.

In these contexts 105 pieces were recovered: Italic, Gaulish and Peñaflor. In addition, there is a specimen of Hispanic *sigillata* that was considered an intrusion. By percentages, the red-gloss Gaulish *sigillata* are the predominant group with 73 specimens (69,52%), followed by Italian (19,04%), marbled Gaulish *sigillata* (6,6%), Peñaflor-type (3,80%) and the single Hispanic *sigillata* (0,95%).

Within the Gaulish *sigillata* the red-gloss version dominates. All identified come from the workshop of La Graufesenque. The morphology of the pieces displays little variety and the types are repetitive. The table service of the period combines the plate Drag. 18 (23,28%) (Fig. 4, 1 and 3) together with the cup Drag. 27 (28,76%) (Fig. 4, 8). There is also a Drag. 27 cup with a cruciform element as *graffito*, the property mark most repeated in *Baelo Claudia*.

Other plain forms collected are the plates Drag. 15/17 (10,95%), with the cup Ritt. 9 (1,36%) (Fig. 4, 7), Ritt. 8 (6,85%) (Fig. 4, 2) and Drag. 24/25 (1,36%), all at lower percentages. As for the decorated types, the preference is for Drag. 30 (15,06%) with very simple decoration. Among the decorative subjects favoured, we highlight the borders with *ovolos* and plant-derived motifs. The following Table 3 lists all the stamps.

Form	Transcription	Potter (Samian Research Database)
Drag. 27	[.] M	-
-	(-)ALIT	-
Drag. 27	OF LVCI	<i>Lucius i</i> (AD 30-65)
-	[.]IIII[.]	-
Drag. 27	[.]CCI	<i>Lucceius i</i> (AD 30-65)
Drag. 27	OF·ANI	<i>Annius i</i> (Nero)
Drag. 27	(-)ALIT	-
Drag. 27 (Fig. 8, 9)	·CO	-
Drag. 27 (Fig. 4, 8)	PA (.)	-

Table 3 – Identified Gaulish stamps of the Neronian phase.

Concerning the marbled *sigillata*, they are but few, most concentrated in the following decades. Drag. 15/17, 27 or Ritt. 8 are the most consumed pieces now.

In numbers recovered, the Gaulish *sigillata* is followed by the Italian. A greater variety of pieces can be defined here. A parity exists between plates and cups, in contrast to what we have seen with the Gaulish, where the cups stand out as the main form. The Italian products come mainly from the Pisa workshop, and to a lesser extent from Arezzo, reversing the pattern of success seen in the previous periods. Among the cups, we highlight Consp. 23.1 (Fig. 4, 9), Consp. 27.1, 33.1, 33.2, 34.1, as well as the large Ritt. 5 and 12. Chronologically, we observe a homogeneity that has allowed us to adjust the dating of these strata to the proposed period. Thus, the forms Consp. 33.1, 33.2, 20.1. and the Ritt. 5 clearly belong to this period alone, being absent in later *facies*. With the plates, we highlight Consp. 4.5 (Fig. 4, 6) and Consp. 19.1, 20.1, 21.3 and 20.4 (Fig. 4, 4). Among them, Consp. 19.1 is what allows us to confirm our proposal. The decorated pieces are scarce and very fragmentary (Fig. 4, 10): we can only observe

some plant-derived motifs and *guilloché* elements. Only two *sigilla* are known (**Table 4**), both in *planta pedis* – one is very fragmentary and in the other we read [.]IT·T·I.

At this period, the Peñaflores-type production suffers a setback, largely because of the influx and quality of the Gaulish *sigillata*. Only imitations of Pompeian red-slip forms have been located – Mart. III, as well as a piece of Mart. I cup (**Fig. 4, 5**). This falling away will increase as the Neronian era goes on.

The single piece of the Hispanic *sigillata* of form 44 recovered we consider as a clear intrusion. We came to this conclusion because this form imitates the Gaulish product that only begins in the later Domitian period (Passelac and Vernhet, 1993: 574). Hispanic *sigillata* production was centred on the second half of the 2nd century (Mayet, 1984: 75), extending into the 3rd, as a context near *Valentia* demonstrates (Escrivá, 1989: 160). In a recent stratigraphical study, carried out by ourselves, we raised the possibility that the start of Hispanic production would occur with the Flavian dynasty, with the Trajanic era marking its greatest splendour (Bustamante, 2013: 209-213).

In addition to the specific chronological input each one of the above pieces makes, the absence of some other forms that later prevail (e.g. Drag. 37 type) make it certain that this series of contexts does not date beyond the middle of the 1st century AD. This fits perfectly with the timing of the earthquake that seems to devastate the city at this time.

SU	Form	Reading	Shape	Potter
111	-	[.]IT·T·I	<i>In p.p.</i>	-
111	-	fingers[.]	<i>In p.p.</i>	-

Table 4 – Identified Gaulish stamps of the Neronian phase.

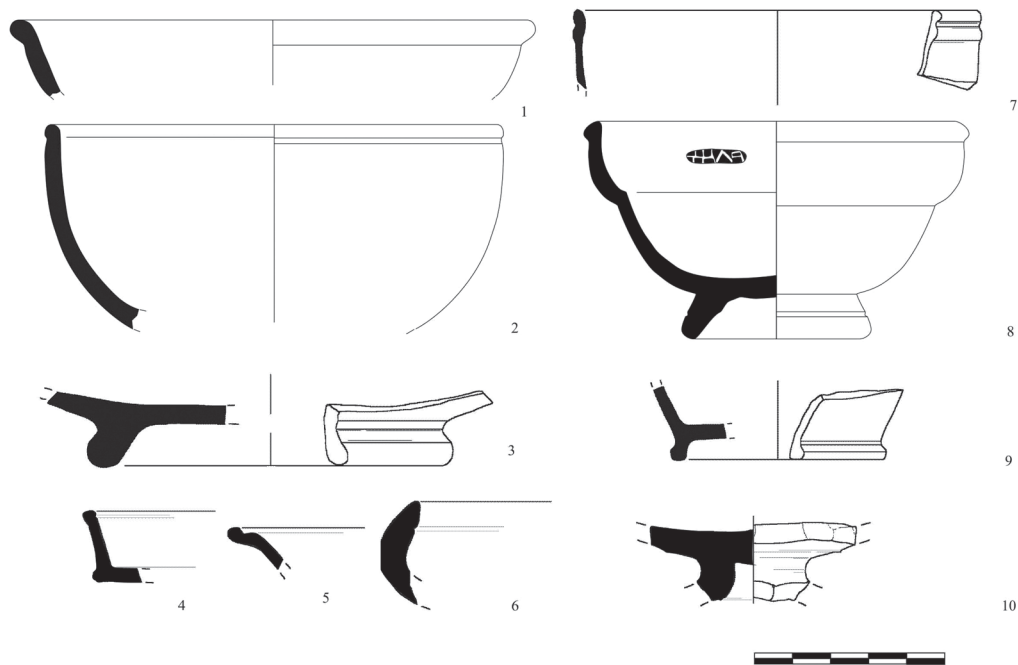

Fig. 4 – Context of the Claudian period. Drag. 18 (1 and 3), Ritt. 8 (2), Drag. 27 (8) and possible variant of Ritt. 9 (7). Peñaflores-type Mart I cup (5). Italic forms of Consp. 4.5 (6), Consp. 20.4 (4), Consp. 23 (9) and R. 1 (10).

2.2. From the Late Neronian period until the end of the 1st century AD

For reasons so far unclear, in Neronian times a garbage dump accumulated at these same city gates (Bernal *et al.*, 2011). Such an event should not surprise us: it seems the slovenly behaviour typical of this period. The dump grew massively in just forty years, from the Late Neronian to the Early Antonine periods. The major importance of this record is that it is both spatially and chronologically limited and so contextualized. The value increases still further when it is realized that the ceramic production undergoes a number of significant vicissitudes: there is the decline of the Gaulish products, the beginning of Hispanic *sigillata figlinae*, as well as the arrival of some of the North African products, most specifically the ARSW-A.

From this chronological *facies*, we identified 761 pieces of fine tableware that are divisible thus: red-gloss Gaulish *sigillata* (65,83%), marbled Gaulish *sigillata* (9,72%), Italic *sigillata* (7,62%), Hispanic *sigillata* (9,85%), ARSW-A (0,65%) and Peñaflores-type (4,46%).

Starting with the analysis of the Italic *sigillata*, its volume is clearly falling away now. There are few fragments to be associated with the types Consp. 19.1 (Fig. 5, 4), Consp. 20.1 (Fig. 5, 11), Consp. 23 and Consp. 20.4 (Fig. 5, 6 and 8). Also, some very fragmentary examples exist that we cannot associate with any particular type (Fig. 5, 1).

Form	Reading	Shape	Potter (Samian Research Database)
-	(.)MIN	<i>In p.p.</i>	
Consp. 23 (Fig. 8, 7))TEI	Rectangular	Ateius O.C.K. 268, 3
Ritt. 9	S·M·P	<i>In p.p.</i>	

Table 5 – Italic stamps located in the Late Neronian phase until the end the 1st century AD.

Concerning the Gaulish forms, even though they are the ones mostly represented, little typological variety is discerned. Only one item can be assigned to the Montans workshop, the others being clearly from La Graufesenque. The table service existing in previous periods – Drag. 27 (Fig. 8, 1-3, 5, 6, 8-9, 11-14 and 23) and Drag. 18 (Fig. 6, 1-3, 6 and 10-15) (with 94 and 90 pieces respectively) – is now expanded. It may also be represented by a service composed of Drag. 15/17 (Fig. 5, 2-3, 7, 9, 12 and 13) and Drag. 24/25 (Fig. 9, 1-2, 4-5, 7, 11-13, 9-10 and 19) (with 40 and 35 pieces respectively). As for other forms, we draw attention to Drag. 22, Drag. 4/22 (Fig. 5, 10 and 14-15), Drag. 35/36 (Fig. 7, 1, 4-6, and 8-9), Ritt. 8 (Fig. 8, 17 and 20-22), Hermet 31, Kn. 78 or Ritt. 9. Among the decorated pieces are to be found Drag. 37 (Fig. 13, 1, 3, 4 and 8-10), followed by Drag. 29 (Fig. 11), Drag. 30 (Fig. 12) and one example of Ritt. 5 (Fig. 13, 5). In all this, it is the form Drag. 35/36, as well as the predominance of Drag. 37, that make up the typological pointers that place the Flavian table service, *par excellence*.

In this period, 27 *specimens* of *sigilla* have been located. Mainly, the potters' stamps were identified on the forms Drag. 27, 18 and Ritt. 8, set in a simple rectangular stamp-frame.

The significant volume of marbled *sigillata* identified at this period is of consequence. Among the forms, Drag. 18 and 27 dominate (with 15 pieces each) and Drag. 24/25 and 15/17 (with 4 pieces each) seem to replicate the table service of the red-gloss Gaulish *sigillata*. Next frequent are the forms Drag. 22, 29, 35/36, with Ritt. 8. The decorations present include plant-derived motifs, as well as the *ovolo*.

In this period (from Late Neronian to Domitian), 9,72% of the fine tableware is of this type of pottery. This data is significantly higher than the percentage earlier given by Bourgeois and Mayet, of 4,3%. Now *Baelo Claudia* is clearly seen as the Hispanic settlement that most prolifically consumed these ceramics: as against 6% in Mérida (Mayet, 1978), 5,2% in Valeria (Sánchez Lafuente, 1985), 2,1% in Tossal

de Manises (Ribera, 1988-89), 4,35% in Cartagena (Castellano, 2000), with 2,9% in *Ilici*, in *Conimbriga* 0,3% (Delgado, Mayet & Alarcão, 1975) and 4% in *Valentia* (Ribera, 1981).

One of the ceramic categories less well represented in this study is the Hispanic *sigillata*. Despite this shortfall, it is yet possible to assess some aspects hitherto not addressed. One odd aspect is that, although it is a regional production, their presence is different when compared to the equivalent Gaulish products. Further, it is a surprise to find that most of the products come from Tricio and not from Andújar: the latter would have been expected, considering the proximity of this production site. Another perplexing aspect is that although production – more specifically that of *Isturgi* – has been attributed to the Tiberian period, the Hispanic products do not appear at *Baelo Claudia* until very close to the Flavian period, and always together with ARSW types.

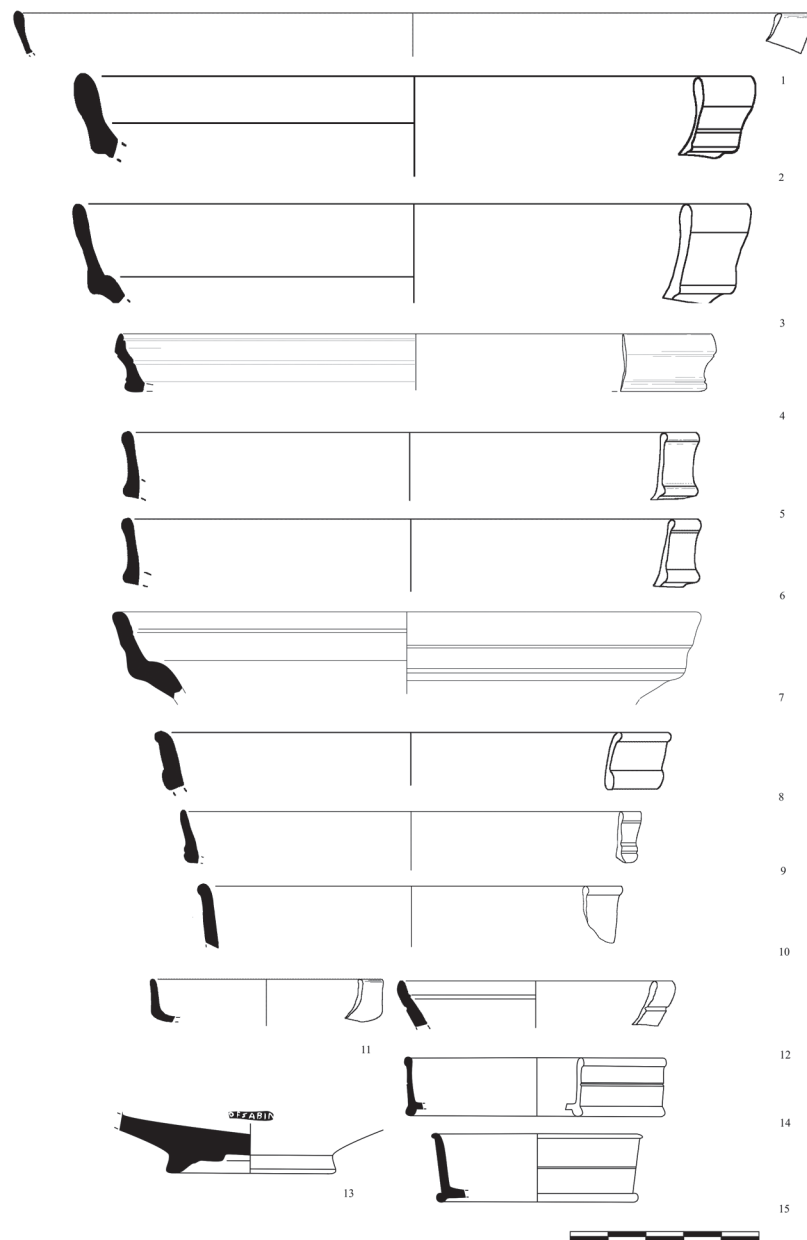

Fig. 5 – Ceramics from the Dump area. Italic *sigillata*: Consp. 19.1 (4), Consp. 20.1 (11), Consp. 20.4 (5-6 and 8), indeterminate form (1), Gaulish *sigillata*: Drag. 15/17 (2-3, 7, 9, 12 and 13) and Drag. 4/22 (10 and 14-15).

Form	Reading	Potter and dye (Samian Research Database)
Drag. 27	OFABIT	<i>Abitus</i> 1-a
Drag. 27 (Fig. 8, 8)	(.)QHD(.)	-
Drag. 27	NIM[.]	<i>Nimius?</i>
Rit. 8 (Fig. 9, 5)	(.)NICI(.)	<i>Nicius</i> i, 10-a
Drag. 27	OFAMAND	<i>Amandus</i> ii, 3-f
Drag. 27	OE-HGH	-
Drag. 27	(.)F COS	<i>Cosius</i> ii
Ritt. 8 (Fig. 8, 17)	(.)M(.)	-
Drag. 27 (Fig. 8, 11)	CRES	<i>Crestus</i>
Drag. 27 (Fig. 8, 23)	OSABIN	<i>Sabinus</i> iii 20- a
-	(.)F-APRIS	<i>Aper</i> i 4- a
Drag. 27 (Fig. 9, 7)	OFIVCVNDI	<i>lucundis</i> iii 3b (AD 70-90)
Drag. 27 (Fig. 8, 13)	SILVANI	<i>Silvanus</i> i 11- a (AD 30-80)
Drag. 18 (Fig. 5, 13)	OFSABIN	<i>Sabinus</i> iii 8c' (AD 50-80)
Drag. 18 (Fig. 6, 1)	VIRTUTIS	<i>Virtus</i> i 8a (AD 50-85)
Drag. 27	IIIII [.]	-
Drag. 27	OFPONT	<i>Pontius</i>
Drag. 18 (Fig. 6, 11)	APRIO	<i>Aper</i> i 9- a
Drag. 27 (Fig. 8, 14)	V	-
Drag. 27	truncated MAY	-
Drag. 27	OLID [.]	-
Drag. 27	[.] APRI	<i>Aper</i> i
Drag. 17 (Fig. 6, 10)	OFMVRRAN	<i>Murranus</i> i 8- u (AD 45-90)
Drag. 27	OFPRIM	<i>Primus</i> iii 12u or u' (AD 40-80)
Drag. 27	OFVITA	<i>Vitalis</i> ii 6d' (AD 70-100)
Ritt. 8	[.]CALV	<i>Calvus?</i>
Ritt. 9 (Fig. 6, 15)	ABVT	-

Table 6 – Gaulish potters' stamps identified from the Late Neronian phase until the end of the 1st century AD.

The pieces that do appear are the common ones in the Hispanic repertoire in its first phase. This is characterized by its clear imitation of other fine ware types: namely the Italic and the Gaulish *sigillata*. Among the pieces, we emphasize the prominent place of Hisp. 27 form (Fig. 8, 4, 10 and 15) and 37, followed by forms Hisp. 15/17, 18 (Fig. 6, 4-5 and 7-9), Hisp. 24/25 (Fig. 9, 3, 6, 8, 14-18), Hisp. 29, 30, 35/36 (Fig. 7, 2-3, 7 and 10-14), Hispanic Hemispherical form Hispanic Hemispherical form (Fig. 13, 6-7), Hisp. 8 (Fig. 8, 16 and 18-19) and 9. No clear ceramic table service is to be observed now, unlike with the Gaulish production. The decorated forms present a very simple syntax: plant-derived motifs, zoned decoration and geometric frames. All are reflections of the extreme poverty of the decorative programs (Fig. 13, 2 and 11). *Sigilla* are not numerous either (Table 7).

Some specimens of Peñaflores-type ceramics were also identified: Mart. I (Fig. 10, 2, 4, 7 and 8), Mart. II (Fig. 10, 3, 5 and 6) and Mart. III types (Fig. 10, 1).

Concerning the ARSW-A, they clearly belong to products of the late 1st century AD, including forms such as Hayes 8A, as well as one Hayes 3C. Other types from the 2nd century AD were identified: some of the last additions to the dump, as is the case of a Hayes 15. The timing of these final moments is also supported by some African cooking ware types, such as Ostia I, 261, as well as Ostia III, 267 (that we date to the first half of 2nd century AD) and a Lamb. 9 (of the second half of the 2nd century).

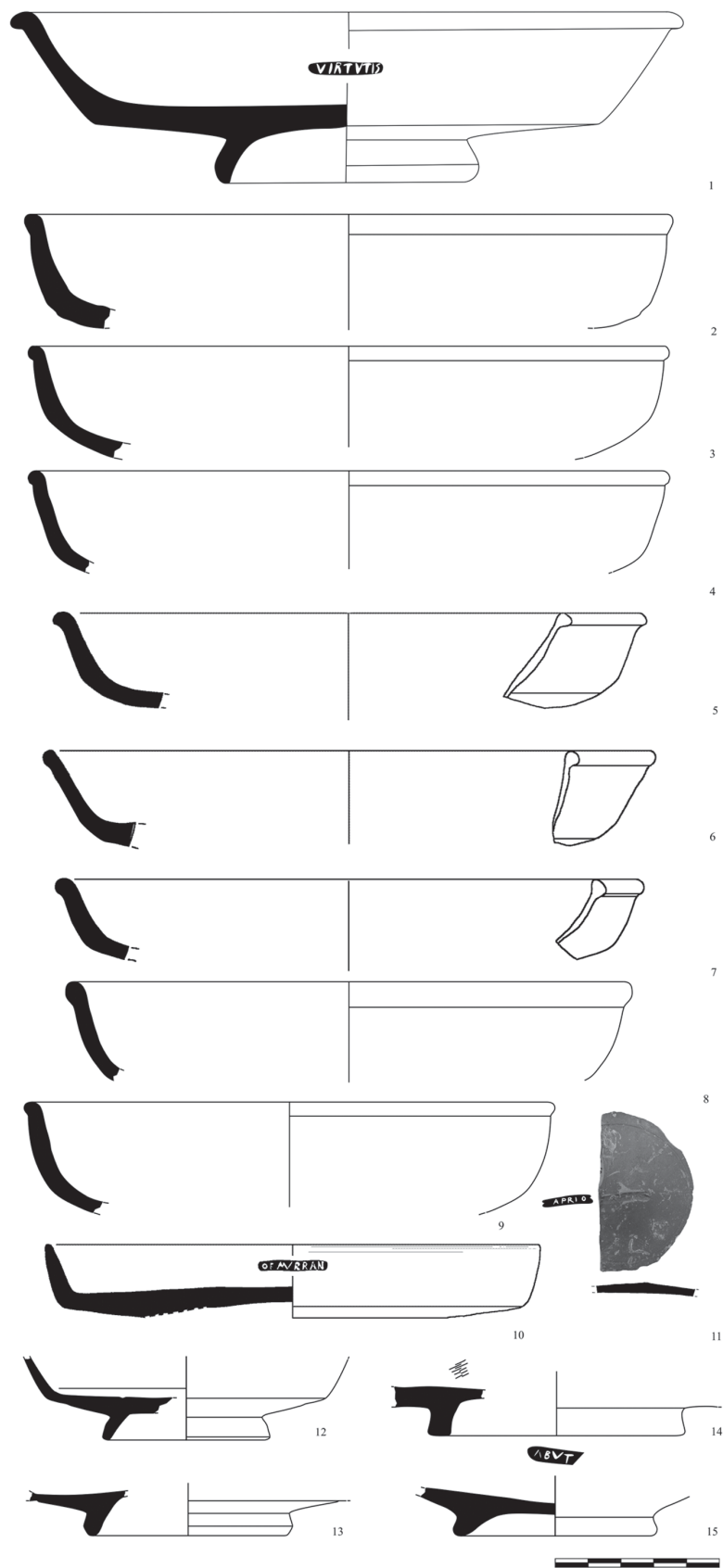

Fig. 6 – Ceramics from the Dump area. Gaulish *sigillata*: Drag. 18 (1-3, 6 and 10-15); and Hispanic *sigillata* form 18 (4-5 and 7-9).

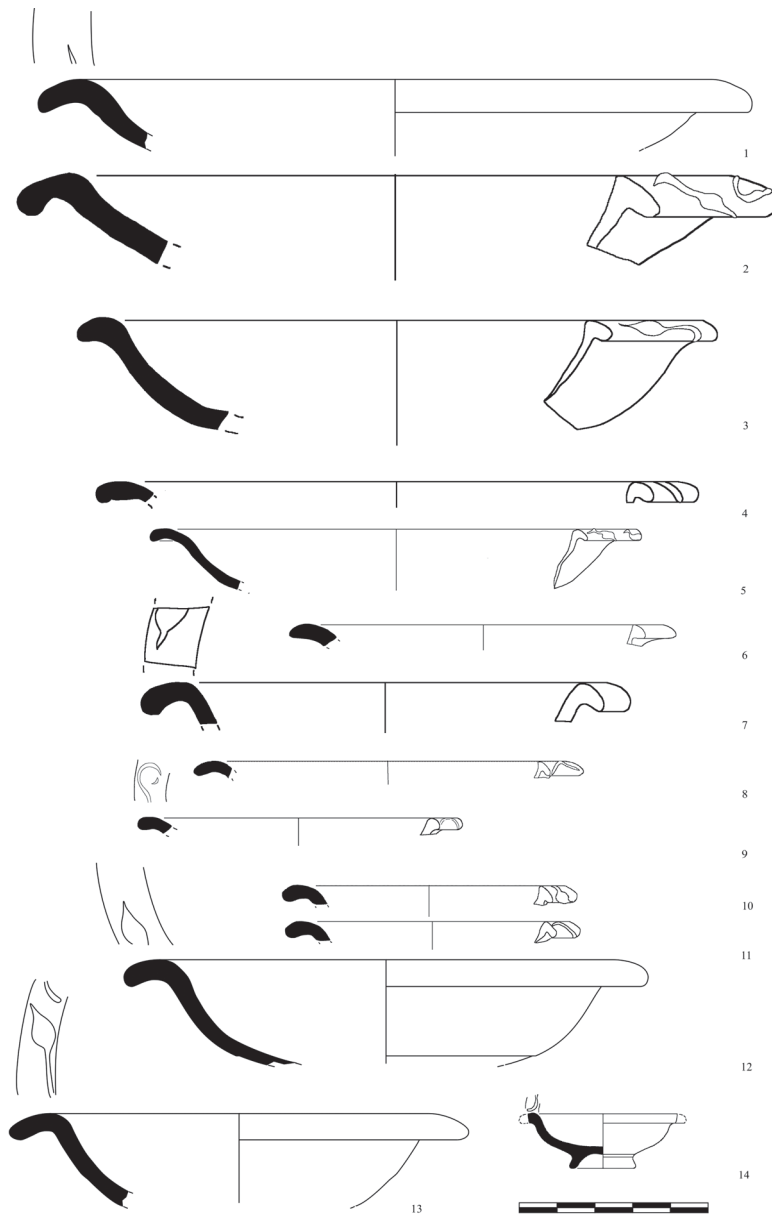

Fig. 7 – Ceramics from the Dump area. Form Drag. 35/36, Gaulish *sigillata* (1, 4-6 and 8-9) and Hispanic *sigillata* (2-3, 7 and 10-14).

Reading	Potter
EXOFCS (S retro) (Fig. 8, 10)	CS
MAT truncated	<i>Maternus</i>
O-S (retro) truncated [.]	<i>Surius</i>
ilegible	-
OF-ANI-F	<i>Anius</i>
truncated ICCI (Fig. 8, 15)	<i>Flaccius</i>
EX O (.)	-
undetermined	-

Table 7 – Hispanic potter’s stamps identified in the late Neronian phase until the end of the 1st century AD.

All the above places the beginning of the accumulation of the detritus in the final moments of the reign of Nero. The imports found are characterized by clearly being items on the Mediterranean distribution circuit, whose activities are dated between the end of Nero's reign and into the 2nd century AD.

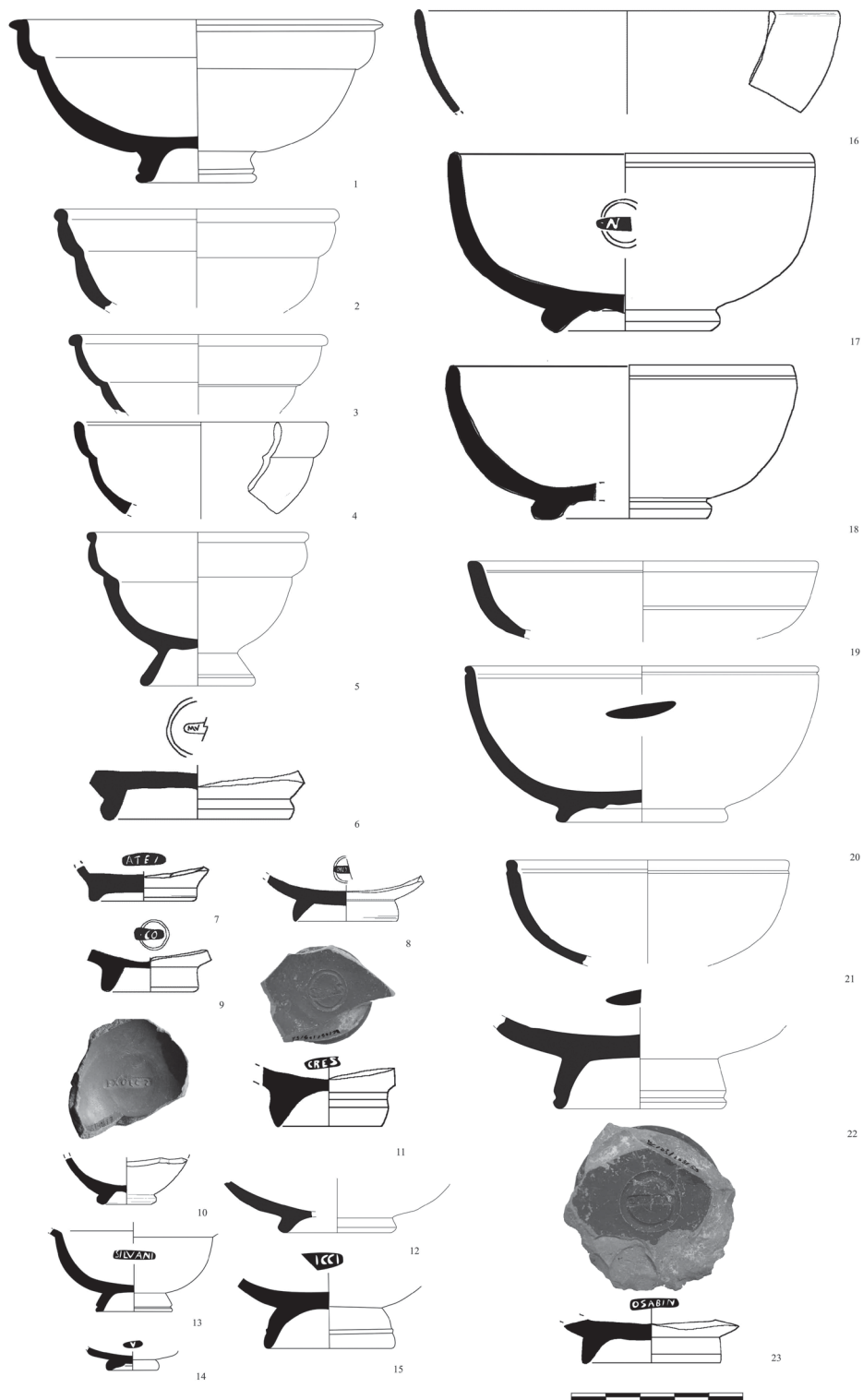

Fig. 8 – Ceramics from the Dump area. Varied cups of Gaulish *sigillata* Drag. 27 (1-3, 5, 6, 8-9, 11-14 and 23), Hispanic *sigillata* form 27 (4, 10 and 15), Ritt. 8 (17 and 20-22), Form 8 (16, 18 and 19) and Italic *sigillata* Consp. 23 type (7).

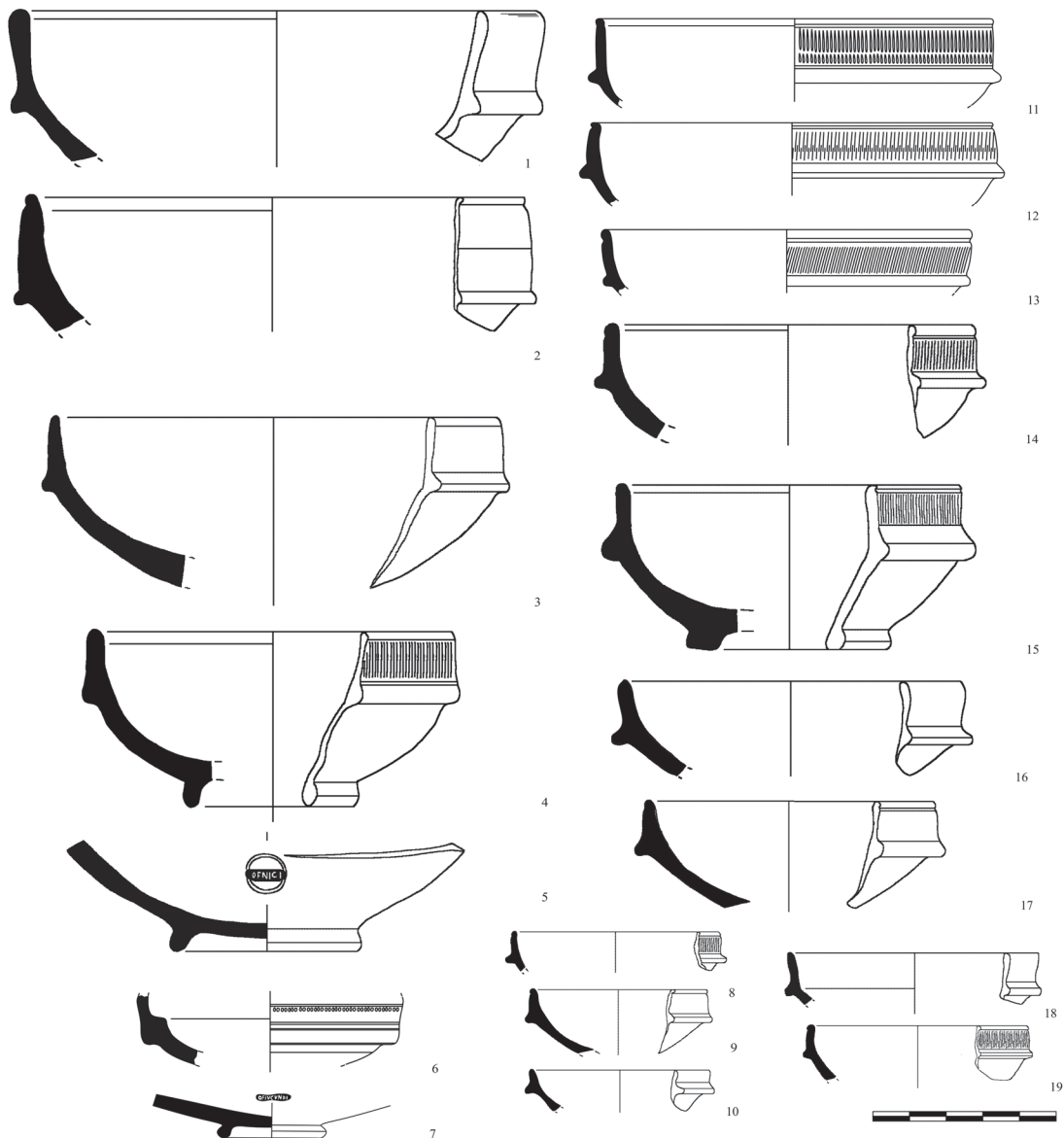

Fig. 9 – Ceramics from the Dump area. Drag. 24/25 in red-gloss Gaulish *sigillata* (1-2, 4-5, 7, 9-13 and 19) and Hispanic *sigillata* (3, 6, 8, 14-18).

To ascertain the starting point of this garbage dump – of Late Neronian date, we used multiple sources of information. In this, the evidence provided by the south Gaulish *sigillata* bulks large. Indeed, the importance of this site in the articulation of the Gaulish trade has been emphasized on several occasions (Sillières, 1977; Bustamante, 2008). As an initial chronological milestone, the reign of Nero was indicated, based on the similarity of material with pieces found in the grave *Du Canal*, *Fronto* and *Cluzel 15* that are dated to the end of this Emperor's reign (Genin, 2007: 71 and 109). Here the appearance of forms Drag. 15-17, 18, 24-25, 27a, as well as Ritt. 8 and 9, is significant. To this may be added *sigilla* that support this chronology (like that of *Sabinus iii* or *Virtus ii*). The wide presence of marbled *sigillata* present assists, when compared with the abundant findings produced in the *fosse Gallicanus*, dated between AD 55 and 60.

Chronological data used to fix this dating are the forms Drag. 35 and 36 (service A), decorated with barbotine trailed leaves. These pieces begin their development in Nero's final years (Genin, 2007: 317), going on to become the Flavian table service, *par excellence* (Vernhet, 1976). This fact, together

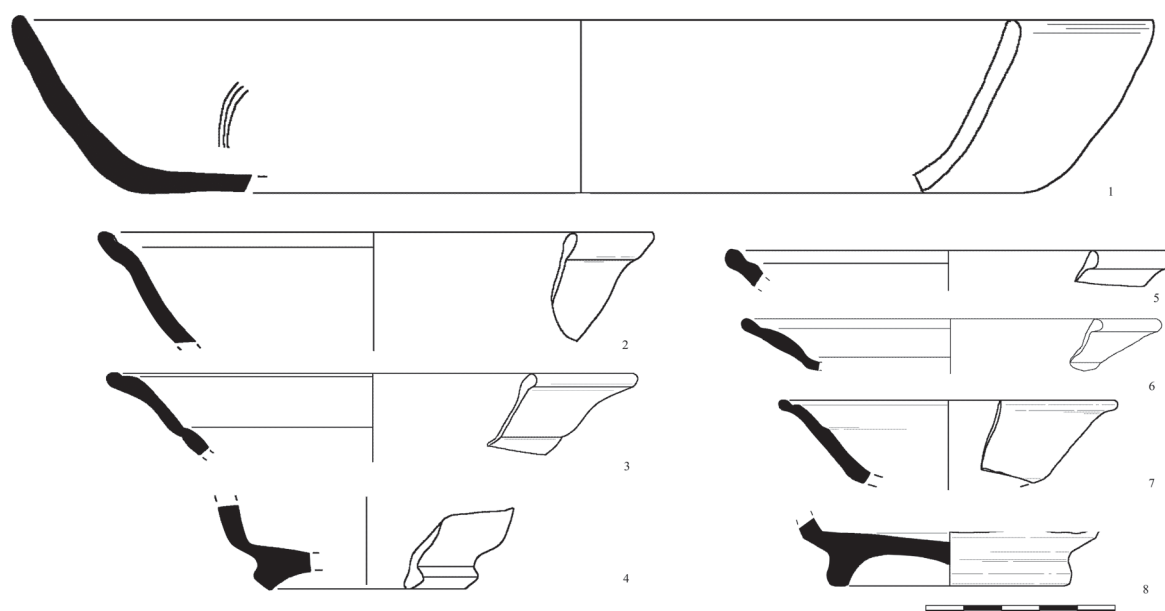

Fig. 10 – Ceramics from the Dump area. Peñaflor-type ceramics: Mart. I (2, 4, 7 and 8), Mart. II (3, 5 and 6) and Mart. III (1).

with a series of decorated forms whose chronological limits coincide with those of the Flavian dynasty, determine the presence of material datable to this period: thus, the presence of forms Drag. 29 and 30 with plant-derived motifs and 'palisades' (Fig. 11 and 12), as well as the absence of Drag. 37 forms that would have acted as a Vespasian indicator. Moreover, the absence of ARSW-A is another relevant chronological marker used to put forward a Neronian dating.

Thus, one can place the beginning of the continuous dumping by the eastern wall of *Baelo Claudia* in the final moments of Nero's reign based on the following reasons:

- the appearance, at least occasional, of the Gaulish 'Service A' formed by Drag. 35-36. Such forms begin their development now, despite the fact that their *floruit* is Flavian.
- the absence of Vespasian pieces, *par excellence*, such as Drag. 37 bowls.
- the abundance of forms in marbled *sigillata* whose main development occurs during the reigns of Claudius and Nero.
- the absence of pieces of Hispanic *sigillata* as well as ARSW-A, which begin their production in the reign of Vespasian.

As for its final moments of use, the dumping clearly ceased in the advanced moments of the 2nd century AD, as an analysis of that *sigillata* and the African cooking wares located in the uppermost surface layers declares.

3. The transition from the 4th to the 5th century AD. The necropolis of the Eastern Gate

At the turn from the 4th to the 5th century AD, the area received a makeover. What had become a large swathe of land formed from urban detritus over the several centuries following the late 1st century AD, now became a necropolis set just outside the city gate. In the studied contexts, we observe a strong modification of them that, in part, are covered by the almost superficial nature of these strata.

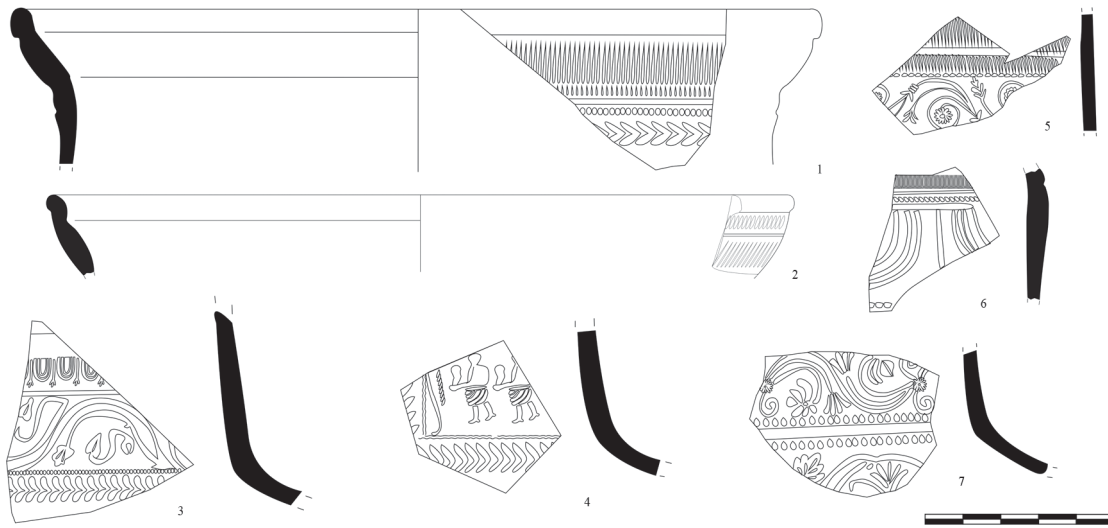

Fig. 11 – Context from the Dump area. Gaulish sigillata Drag. 29.

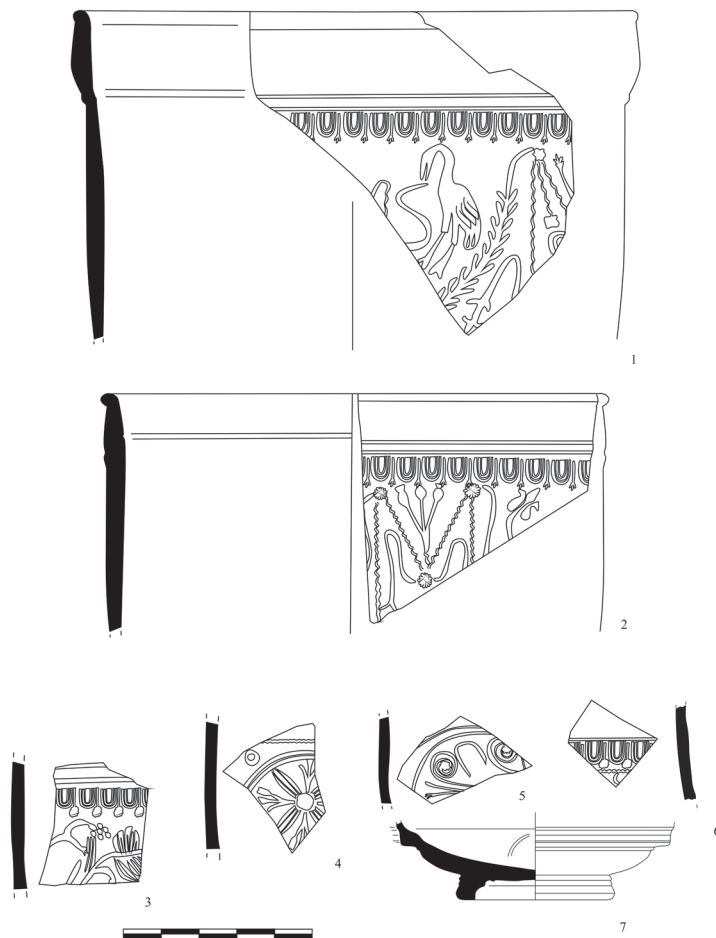

Fig. 12 – Context from the Dump area. Gaulish sigillata Drag. 30.

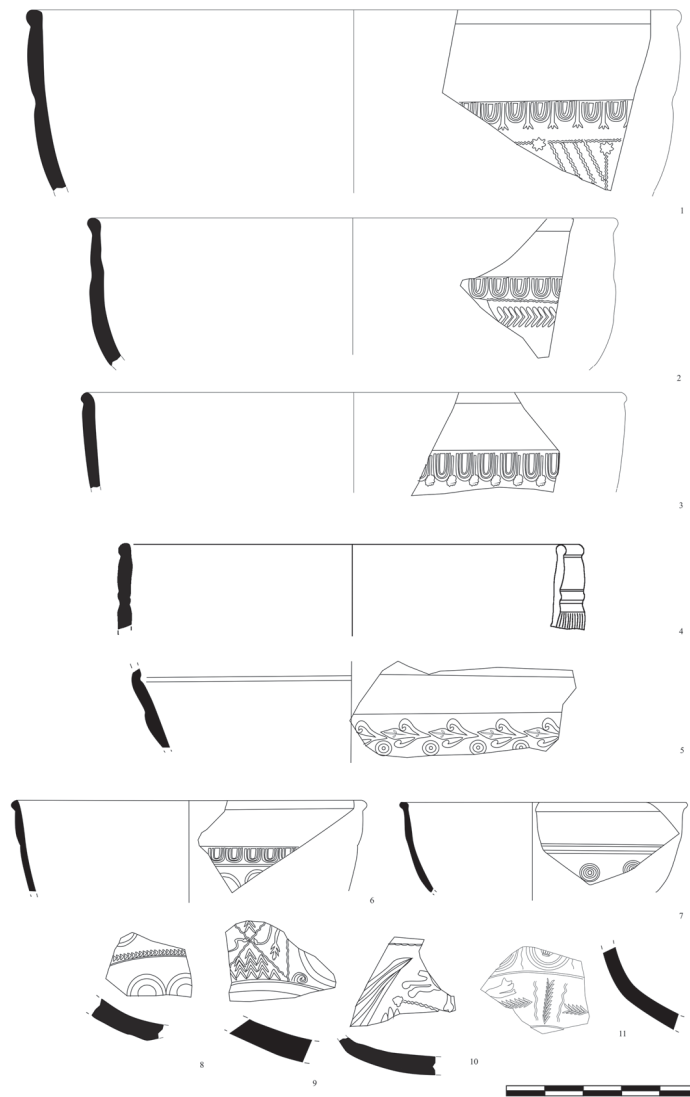

Fig. 13 – Context from the Dump area. Gaulish *sigillata* Drag. 37 (1, 3, 4, 8) and from Montans (9 and 10); Hispanic *sigillata* form 37 (2 and 11), Hispanic hemispherical decorated form (6 and 7) and fragment of Ritt. 5 in italic *sigillata* (5).

Of the 56 identified pieces, the ARSW-A (at 3,57%), ARSW-D (8,92%), 'Luisante' (1,78%), orange DSP (the so-called *Derivée de Sigiliée Paléochrétienne*) (1,78%) stand out, alongside considerable remnants of redistributed Early Empire ceramics, such as Hispanic *sigillata* (12,5%), Italic (14,28%), marbled (5,35%) or red-gloss Gaulish *sigillata* (41,09%).

It is the ARSW-D that provides the chronological fine-tuning of these moments. Among the pieces, some forms of Hayes 67 and 76 appear (Fig 14, 4-5) from the turn between the 4th and the 5th centuries AD; a single Hayes 61A (Fig 14, 6) is to be similarly dated, as well as some indeterminate examples, (one Hayes 124 type with stamped decoration of a palmette is worth mentioning) (Fig 14, 3).

For the ARSW-A material, a piece of Hayes 8 is significant, dating as it does from the middle of the 2nd century AD (Bonifay, 2004: 156) and likewise a Hayes 27 typical of the 3rd century AD (Bonifay, 2004: 159). Concerning ARSW-C, three specimens are identified: one is a Hayes 50 from the middle of 3rd century AD, another a Hayes 53 dated from the end of the 4th to the beginning of the 5th centuries AD.

Of even later date is a fragment of a cup in the 'Luisante' ceramic, as well as another in DSP with a small central stamped decoration.

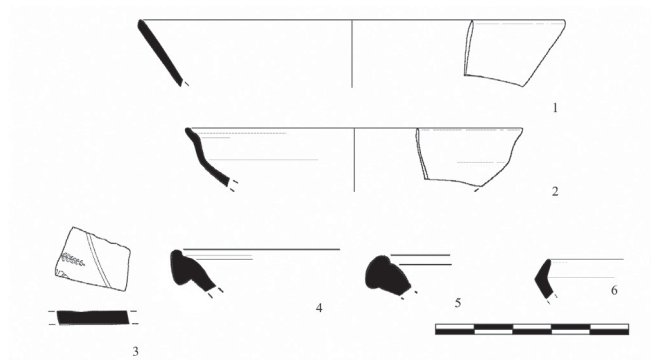

Fig. 14 – Ceramic context associated with the Late Roman necropolis. Hispanic *sigillata* form 15/17 (1), Late Hispanic undetermined form (2) ARSW-D with stamped decoration (3), Hayes 67 (4), Hayes 76 (5) and Hayes 61A (6).

As we will show in the following paragraphs, this area was slowly abandoned, a process accompanied by strong post-depositional activity that led to the presence of a huge amount of residual pieces. These include Hispanic *sigillata*, in the forms 35, 37, 15/17 or 8. There appears here a stamp, [.] IRM, that we associate with the potter *Firmus*. Amongst the Italic *sigillata*, Consp. 12.1, 18.2., 23 deserve mention. Gaulish *sigillata* too is well represented: no surprise, considering that it is the predominant type in *Baelo Claudia*. From these last, the forms Drag. 15/17, 18, 24/25, 27, 30, 33, 35/36 or 37 stand out.

4. End of the 5th century. The beginning of the abandonment of the area

At the end of the 5th century, a slow abandonment process begins. The contexts involved are characterized by a strong pattern of residual material, in the presence of abundant ceramics from Early Imperial period, namely Hispanic *sigillata*, Gaulish *sigillata*, as well as ARSW-A. Accordingly, in addition to the stratigraphy, the presence of ARSW-D allows the chronology to be correctly dated.

We identified 16 pieces: they are divided between ARSW-D (33,33%), ARSW-A (12,12%), ARSW-C (0,33%), Late Phocaean red-slip ware (0,33%), as well as Hispanic *sigillata* (0,66%), marbled (0,66%) and red-gloss Gaulish *sigillata* (6,06%), all clearly residual and from the Early Empire.

The ARSW-D gives the finest chronological precision to these contexts: a Hayes 94A, dated between the end of the 5th and the beginning of the 6th centuries AD, one Hayes 91 B/C from of the middle of the 6th century (Bonifay, 2004: 179) and finally a Hayes 104B dated to the second third of the 6th century (Bonifay, 2004: 183). Among the fragments, one shows a circle stamped decoration (Hayes 18 type) and another has a circular geometrical element and a thorn (Hayes type I).

One of the clearest elements to define this moment chronologically is a specimen of Hayes 3C type in Phocaean *sigillata*. Despite the fact that such are very rare pieces indeed in southern Iberia contexts, in *Baelo Claudia* several examples have been already identified (Sillières, Rouillard and Remesal, 1979: 399; Alonso, 1994: 391-395; Bourgeois and Mayet, 1991). The largest volume of imports to the Iberian Peninsula should be taking place from the 5th to the 6th centuries (Reynolds, 1995: 35): which is exactly the period to which we date these contexts.

Residually, there are pieces of ARSW-A, such as a Hayes 3B from the initial Antonine period, a Hayes 16 dated from the end of the 2nd and beginning of the 3rd centuries AD (Bonifay, 2004: 159) and a Hayes 9 also from the 2nd century AD. Among the residual forms are known some Hispanic *sigillata* of types 37 and 15/17 clearly dating from Early Imperial phase. It should be noted that the intermediate and late products are almost absent in the south of the Iberian Peninsula, with the exception of some fragments located very sporadically, namely the *Iulia Traducta* specimens, as well as in *Carteia*, and they were not detected in *Baelo*.

Finally, there are also pieces of Gaulish *sigillata*, both marbled and red-gloss. Here, Drag. 18 and 30 forms stand out, as well as some more indeterminate pieces. Again, we insist they are of clear residual nature.

5. Conclusions

The investigations carried out by the eastern wall of *Baelo Claudia* are characterized by a rather precisely attributable chronological set of *facies*:

- first phase: at the beginning of the Julio-Claudian dynasty, associated with the construction of the wall.
- second: from Claudius' time, linked to the repairs that the wall and many other buildings needed after a likely seismic event.
- third: spanning from the Late Neronian period until the reign of Hadrian, a large accumulation of urban debris (garbage dump).
- fourth: a late necropolis, from the end of the 4th into the beginning of the 5th century AD.
- fifth and final: a slow abandonment process, that begins at the end of the 6th century AD.

The goal was to assess the ceramic groups chronologically, and as 'snapshots', so revealing what the pieces were consumed at those specific periods (**Fig. 15**).

The best-represented contexts are the Early Imperial ones; the subsequent horizons are more limited—involving both relatively little contemporary discards and at times considerable residual materials. Such a pattern is typical of the dynamic of these 'garbage dumps', where soil can become churned up, and dumped from sources containing earlier material. Even so, methodologically, these sort of areas, from their long-life and their constant growth from rubbish disposal of different natures, may be particularly suitable for typo-chronological studies, composed, as they are, from material drawn from a mixed set of sources.

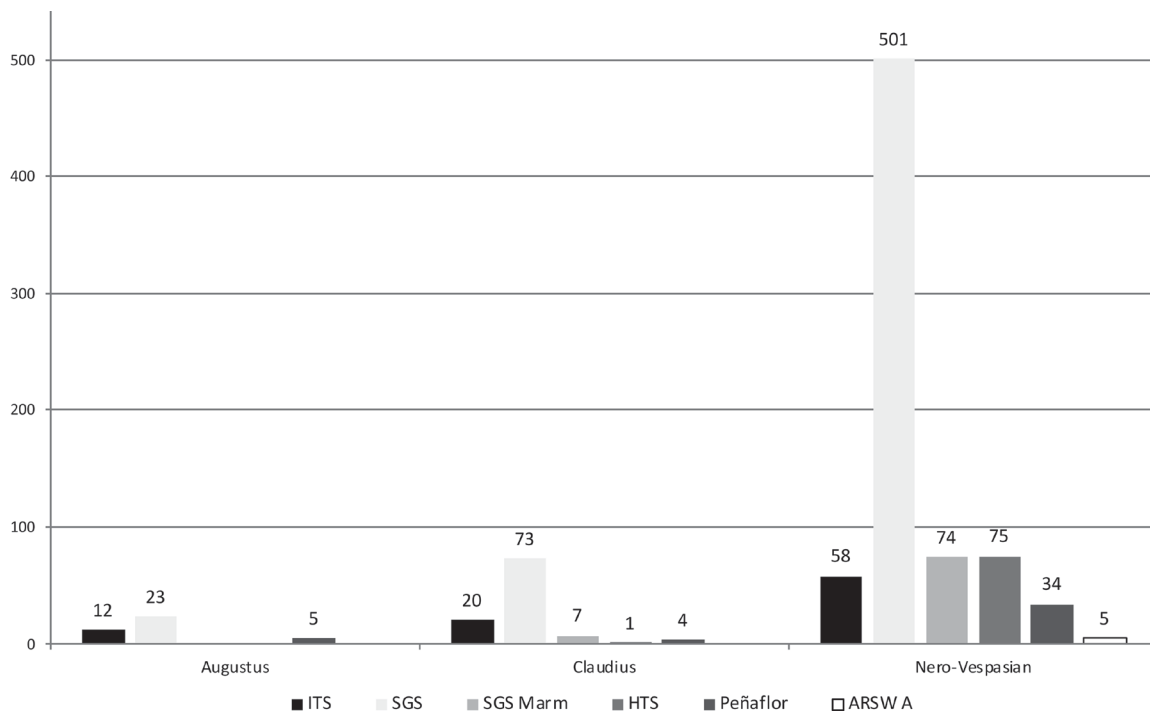

Fig. 15 – Evolution of the Early Imperial ceramic trade, by category and chronology.

SU	Production	Tipology	Figure
T1	Gaulish TS	Drag. 30	12, 7
Trinchera 1	Italian TS	Consp. 18	3, 2
101	ARSW-D	Hayes 76	14, 5
103	Gaulish TS	Rit. 8	8, 17
	Hispanic TS	Hisp. 8	8, 18
104	Gaulish TS	Drag. 37	13, 8; 13, 10
	Gaulish TS	Drag. 27	8, 9 (-CO stamp)
	Gaulish TS	Drag. 29	11, 4; 11, 7
	Gaulish TS	Drag. 30	12, 6
	Gaulish TS	Drag. 37	13, 9
105	Gaulish TS	Drag. 15/17	5, 2
	Gaulish TS	Drag. 18	6, 11 (Aper stamp)
	Gaulish TS	Drag. 27	8, 6 (Mu[.]stamp); 8, 11 (Crestus stamp); 8, 23
	Hispanic TS	Hisp. 8	8, 16
	Gaulish TS	Drag. 24/25	9, 2; 9, 4
	Hispanic TS	Hisp. 24/25	9, 3; 9, 14; 9, 15; 9, 16
	Peñaflor type	Mart. I	10, 2; 10, 4
107	Peñaflor type	Mart. II	10, 5
	Gaulish TS	Drag. 29	11, 5
	Italic TS	Consp. 20.1	5, 11
	Gaulish TS	Drag. 27	8, 5
	Gaulish TS	Drag. 24/25	9, 7 (lucundus stamp)
	Gaulish TS	Drag. 29	11, 3
109	Gaulish TS	Drag. 15/17	5, 7; 5, 13
	Gaulish TS	Drag. 4/22	5, 14; 5, 15
	Gaulish TS	Drag. 18	6, 1; 6, 14
	Gaulish TS	Drag. 27	8, 13 (Silvanus stamp); 8, 14 (V stamp)
	Gaulish TS	Drag. 24/25	9, 12
	Gaulish TS	Drag. 29	11, 1; 11, 2
	Gaulish TS	Drag. 30	12, 1; 12, 2
110	Hispanic TS	Hemispherical decorated Form	13, 7
110	Hispanic TS	Hisp. 27	8, 15 (Flaccus stamp)
135	Peñaflor type	Mart. II	10, 6
202	Hisp. TS	Hisp. 18	6, 9 (residual)
302	ARSW-D	Indet.	14, 3
	ARSW-D	Hayes 61a	14, 6
303	Gaulish TS	Drag. 35/36	7, 6; 7, 8
	Gaulish TS	Drag. 35/36	7, 5
	Hispanic TS	Hisp. 35/36	7, 10; 7, 11
304	Hispanic TS	Hisp. 27	8, 4
	Hispanic TS	Hisp. 24/25	9, 8
	Gaulish TS	Drag. 24/25	9, 10
	Hispanic TS	Hisp. 37	13, 11
305	Gaulish TS	Drag. 15/17	5, 3
	Gaulish TS	Drag. 18	6, 3; 6, 6
	Hispanic TS	Hisp. 35/36	7, 13
306	Gaulish TS	Drag. 24/25	9, 19
	Gaulish TS	Drag. 37	13, 1

Table 7 – Inventory of pieces analyzed in this paper according to Stratigraphic Units (SU).

SU	Production	Typology	Figure
307	Italic TS	Consp. 19.1	5, 4
	Peñaflor type	Mart. I	10, 7; 10, 8
	Italic TS	R. 5	13, 5
308	Italic TS	Consp. 20.4	4, 4
	Peñaflor Type	Mart. I	4, 5
	Italic TS	Consp. 4.5	4, 6
	Italic TS	R. 1	4, 10
400	Gaulish TS	Drag. 15/17	5, 9
	Italic TS	Consp. 23	8, 7 (Ateius stamp)
401	Gaulish TS	Drag. 27	8, 8 ((.)OHD(.) stamp)
	Gaulish TS	Drag. 27	8, 10 (EXOFCS)
402	Gaulish TS	Drag. 18	3,3; 6,8
	Hispanic TS	Hisp. 35/36	7, 2
	Peñaflor type	Mart. III	10, 1
404	Gaulish TS	Drag. 15/17	3, 1
	Italic TS	R.3.1.	3, 13 (residual, CR(.)F stamp)
	Italic TS	Indet.	5, 1
	Italic TS	Consp. 20.4	5, 5; 5, 6; 5, 8
	Gaulish TS	Drag. 18	6, 10 (Murranus stamp)
	Gaulish TS	Drag. 24/25	9, 5 (Senicio stamp)
405	Peñaflor type	Mart. II	10, 3
	Gaulish TS	Ritt. 9	3, 8 (VI stamp)
406	Italic TS	Consp. 20	3, 4
407	Gaulish TS	Indet.	3, 9
	Italic TS	R. 3.1	3, 10
502	Gaulish TS	Drag. 27	3, 5
	Gaulish TS	Ritt. 9	3, 6
	Gaulish TS	Drag. 18	3, 7 (E.)O stamp)
	Gaulish TS	Drag. 24/25	3, 11
	Italic TS	Consp. 50.3.1	3, 12
503	Gaulish TS	Drag. 18	4, 3
	Gaulish TS	Ritt. 9	4, 7
604	Italic TS	Consp. 23	4, 9
604	Gaulish TS	Drag. 30	12, 3 (intrusion)
605	Hispanic TS	Hisp. 35/36	7, 14
607	Hispanic TS	Indet.	14, 2
	ARSW-D	Hayes 67	14, 4
609	Hispanic TS	Hisp. 18	6, 5; 6, 7
	Gaulish TS	Drag. 35/36	7, 9
701	Gaulish TS	Drag. 35/36	7, 4
	Gaulish TS	Drag. 15/17	5, 12
	Hispanic TS	Hisp. 18	6, 4
	Gaulish TS	Drag. 35/36	7, 1
	Hispanic TS	Hisp. 35/36	7, 3; 7, 7; 7, 12
	Gaulish TS	Drag. 27	8, 2; 8, 3; 8, 12
	Gaulish TS	Rit. 8	8, 22
702	Gaulish TS	Drag. 24/25	9, 13
	Gaulish TS	Drag. 29	11, 6
	Hispanic TS	Hisp. 37	13, 2
	Gaulish TS	Drag. 37	13, 3
	Hispanic TS	Hemispherical decorated Form	13, 6

Table 7 (cont.) – Inventory of pieces analyzed in this paper according to Stratigraphic Units (SU).

SU	Production	Typology	Figure
706	Gaulish TS	Drag. 18	6, 2; 6, 12; 6, 13; 6, 15 (ABVT? stamp)
	Hispanic TS	Hisp. 8	8, 19
	Gaulish TS	Rit. 8	8, 20; 8, 21
	Hispanic TS	Hisp. 24/25	9, 6
707	Gaulish TS	Drag. 24/25	9, 11
	Gaulish TS	Drag. 18	4, 1
	Gaulish TS	Ritt. 8	4, 2
	Gaulish TS	Drag. 27	4, 8
	Gaulish TS	Drag. 4/22	5, 10
Indet.	Gaulish TS	Drag. 27	8, 1
	Gaulish TS	Drag. 24/25	9, 1; 9, 9;
	Hispanic TS	Hisp. 24/25	9, 17; 9, 18
	Gaulish TS	Drag. 30	12, 4; 12, 5
	Gaulish TS	Drag. 37	13, 4

Table 7 (cont.) – Inventory of pieces analyzed in this paper according to Stratigraphic Units (SU).

In addition to the chronological assessments indicated above, this ceramic study, by offering material from a wide variety of contexts, demonstrates the consequence of the site as a hub for the articulation of trade in the south of the Iberian Peninsula.

Drawing conclusions by ceramic types, the Italic *sigillata* naturally appear in the Augustan period, this being the only moment possible in which to observe their predominance. Later on, this material will even so always less visible than the Gaulish and Hispanic *sigillata*. The main Italic centres that supply *Baelo Claudia* are Arezzo (32%) and Pisa (66%). Chronologically, Arezzo imports are the earlier, and especially to be seen in the Augustan period. However, as time progresses, Pisa wins out. In addition, we have located some fragments (they do not reach 2%), especially in the Late-Neronian contexts, whose production centre is not yet placed.

The ceramic class that is close to dominating the entire commercial circuit is clearly the Gaulish *sigillata*. The beginning of its arrival here could be around the Tiberian period, and its presence increases progressively until the Claudio-Neronian era, when it reaches its peak. In the Flavian era, trade began to fall off. In part, this phenomenon can be explained by the competition offered by Hispanic *sigillata*, as well as North African versions. However, unlike what happens in other sites, this area does not seem to experience a very traumatic decline, but a rather more gradual process of decrease (Bustamante, 2008: 512). Undoubtedly, La Graufesenque remains the supplier centre *par excellence* of Gaulish *sigillata*. Only, a fragment or so from the Montans workshop were found (Fig. 13, 2 and 11). This confirms in a vague way several earlier observations on commercial contacts with the south of the Iberian Peninsula: namely that the trade of this workshop south of the Tagus River is sporadic.

Typologically, the forms are the basic ones of the Gaulish repertoire, concentrated on the two table services previously mentioned – Drag. 24/25-15/17, and Drag. 27-18/31 (Bustamante, 2010: 167). They are now perceived here in an even greater intensity. It is interesting to highlight the considerable volume of pieces of Drag. 4/22 from the Neronian era, something that had not before been identified for this area of the city (Bourgeois and Mayet, 1991; Bustamante, 2010: 167). Though it was already known on other side of the Straits, in the case of *Lixus* (Limane, 2004: Fig. 6b). These ceramics are usually rare types in the Iberian record: thus it is of interest to establish this region as one with a tightly focused distribution circuit. This patterning is also to be observed when assessing the high volume of marbled *sigillata* consumed in the area, which much exceeds the volume in other places. As for the most prolific potters, none seems to hold undisputed sway, a fact that we continuously perceive in the area. *Cosius*, *Aper*,

Copiro, *Mommo*, *Lucundus*, *Vitalis*, *Sabinus*, *Montanus*, *Virtus* or *Rufinus* are the potters identified and in general are those that usually appear throughout this area (Bustamante, 2008: 508 and 512; 2010). This huge amount of Gaulish *sigillata* may explain the importance of wine amphorae coming from Southern France, especialmente in the I-II c. AD, as evidenced in many contexts at *Baelo Claudia*, even with stamps like ALBIN or SEX VIBI RESCENTIS (Bernal, 1997: 445-446).

Of the Hispanic *sigillata*, 25% comes from Andújar, while the remaining 75% is from La Rioja, which provokes some surprise given the proximity of the manufacturing centre of *Isturgi*. Despite received wisdom, *Baelo* is the *nucleus* with the highest concentration of these pieces in the region; hence the town could have been a focal distribution point into *Mauretania Tingitana* (Bustamante, 2010: 174). The potters *Surius*, *CS*, *Maternus*, *Anius* or *Flaccius* are a few identified in the excavation: all had already been confirmed in the *Círculo del Estrecho* (Bustamante, 2010).

The influx of Hispanic *sigillata* in the studied stratigraphy establishes their time of arrival in the Flavian period. This later dynamic, in terms of the arrival of Hispanic products, not only occurs here, but also can be observed at other archaeological areas in *Baelo*. One of the most typical cases is in the southwest necropolis of *Baelo Claudia* (Remesal, 1979). *Baelo Claudia*, it should here be remembered, is a very important commercial port in the south of the Iberian Peninsula. It was especially valuable as an export bridge to the north coast of *Mauretania Tingitana*. Therefore, fine tableware, of whatever production, should be well represented from whenever each sort began to be made: the Hispanic products are no exception. The study of this southwest necropolis shows its long utilization, from the time of Claudius until the Flavian era (Remesal, 1979: 46), coinciding with the dating traditionally proposed for the start of the Andújar production. When analyzing the ceramic contexts, we observe the total absence of Hispanic productions, both from *Tarraconensis* as well as from *Baetica*. On the other hand, Peñaflor-type ceramics were identified, as well as South Gaulish *sigillata* typical of pre-Flavian period, with highly informative *sigilla* (*Cocus*, *Momo*, *Modestus*, *Genialis* or *Martialis*). As far as this study is concerned, it is clear that the first contexts with Hispanic *sigillata* occur in the initial Flavian period, since at all times they are accompanied by ARSW-A. But is this a position exclusive to *Baelo Claudia*, or can one expand this dating association to the entire production?

Among other ceramic categories that have been located is the Peñaflor-type, which turns up anywhere in the entire stratigraphic record, from the Augustan period onwards. The fabrics present a clear homogeneity, that we believe could source from the surroundings of the Cádiz Bay (Bustamante and Huguet, 2008; Bustamante and López Rosendo, 2014) and not from the Peñaflor site, since they show the small granate inclusions, one of the most typical of the Cadiz area. The forms can be placed in the repertoire generated by Martínez (1987; 1989). Concerning the types, in the first contexts, the pieces imitate the Italic *sigillata* forms, while later on the great plates, imitating Pompeian red slip, are usually the most frequent pieces.

As to the African *sigillata*, due to the dating of the excavated contexts they are very constrained in number and forms. Thus the most numerous are the later ones, which are especially to be seen when the Late Roman necropolis is starting. ARSW-C are the least represented: which fact may in part indicate a decline of commercial networks at this period, perhaps reflecting the crisis that seems to haunt the entire Mediterranean or just reflecting the dynamics of these stratigraphic context. The identified pieces are mainly from the Antonine period and again in the late 5th century AD, witness to an intense trade with the Eastern Mediterranean lasting until the 6th century AD. As for the other identified ceramic types, the 'Luisante' ceramics and the orange DSP are represented by but a single example apiece.

Acknowledgement

This study is result of the projects GARVM II (HAR2016-78691-P) funded by MINECO (Government of Spain/FEDER), ARQUEOSTRA (201800104415) of the Programa Operativo FEDER Andalucía 2014-2020; of the funding of the PALARQ Foundation to the University of Cádiz (2019), and the SACEiMAR Project 'De Baelo Claudia (Bologna) a Sexi Firmum Iulium (Almuñécar). Análisis del comercio marítimo a partir de los contextos cerámicos' (CEiMAR Foundation, University of Cádiz and University of Granada).

BIBLIOGRAPHY

- ALONSO DE LA SIERRA, J. (1994) - Cerámicas focas de barniz rojo (Late Roman C) en el valle del Guadalquivir y el Estrecho de Gibraltar. *Actas de la III Reunión de Arqueología Cristiana Hispánica*, Barcelona, p. 391-395.
- ARÉVALO, A.; BERNAL-CASASOLA, D.; MUÑOZ, A.; GARCÍA, I.; MACÍAS, M. (2006) - El mundo funerario tardorromano en Baelo Claudia. Novedades de las intervenciones arqueológicas del 2005 en la muralla oriental. *VI Jornadas Cordobesas de Arqueología Andaluza. Espacios y usos funerarios en la ciudad histórica (Córdoba, 2006)*, *Anales de Arqueología Cordobesa*, 17, Córdoba, p. 61-84.
- ARÉVALO, A.; BERNAL-CASASOLA, D.; MUÑOZ, A.; GARCÍA, I.; CANTILLO, J.J.; BUSTAMANTE, M.; SÁEZ, A.; MACÍAS, M. (2016) - Recientes actuaciones arqueológicas en la muralla oriental y en la necrópolis tardorromana de Baelo Claudia. *II Jornadas Internacionales de Baelo Claudia* (Cádiz and Baelo Claudia, 2010), Sevilla, p. 215-236.
- BERNAL-CASASOLA, D. (1997) - *Economía y comercio de la Bética mediterránea y del Círculo del Estrecho en la Antigüedad Tardía a través del registro anfórico*, Unpublished PhD Dissertation, Madrid: Universidad Autónoma de Madrid, 1997.
- BERNAL, D.; ARÉVALO, A.; MUÑOZ, A.; GARCÍA, I.; BUSTAMANTE, M.; SÁEZ, A. (2011) - Baelo Claudia, *Anejos de Archivo Español de Arqueología*, Mérida: CSIC, p. 65-92.
- BONIFAY, M. (2004)- *Études sur la céramique romaine tardive d'Afrique*, Oxford: BAR International Series.
- BOURGEOIS, A.; MAYET, F. (1991) - *Belo VI. Les sigillées. Fouilles de Belo*, Madrid: Casa de Velázquez.
- BUSTAMANTE ÁLVAREZ, M. (2007, ined.) - *El comercio de Terra Sigillata Alto-Imperial en el Círculo del Estrecho. Balance historiográfico y nuevas líneas de investigación*, Universidad de Cádiz.
- BUSTAMANTE ÁLVAREZ, M. (2008) - Terra sigillata gálica en el Círculo del Estrecho. Balance historiográfico y nuevas líneas de investigación, *SFECAG. Actes du Congrès de l'Escala*, 2008, p. 503-527.
- BUSTAMANTE ÁLVAREZ, M. (2010) - *El comercio de Terra Sigillata Alto-Imperial en el Círculo del Estrecho. Balance historiográfico y nuevas líneas de investigación*, BAR International Series, 2148.
- BUSTAMANTE ÁLVAREZ, M. (2013)- *Terra Sigillata Hispánica en Augusta Emerita (Mérida, Badajoz). Valoración tipocronológica a partir de los vertederos del suburbio norte*, *Anejos de Archivo Español de Arqueología*. Mérida: CSIC.
- BUSTAMANTE ÁLVAREZ, M.; HUGUET ENGUITA, E. (2008)- Las cerámicas tipo Peñaflor. In BERNAL, D.; RIBERA, A. (eds.) - *Cerámicas hispanorromanas. Un estado de la cuestión*, Cádiz: Universidad de Cádiz, p. 297-307.
- BUSTAMANTE ÁLVAREZ, M.; LÓPEZ ROSENDO, E. (2014) - Las imitaciones locales de Terra Sigillata en la bahía de Cádiz. In FERNÁNDEZ, F.J.; García Vargas, E. (ed.) - *Comer a la moda: imitaciones de vajilla de mesa en Turdetania y la Bética occidental durante la Antigüedad*. Col.leció Instrumenta, Barcelona, p. 271 – 300.
- CASTELLANO CASTILLO, J.J. (1993) - Terra Sigillata marmorata en Cartago Nova. *XXII Congreso Nacional de Arqueología*, Vol. I, Madrid, p. 207-212.
- DELGADO, M.; MAYET, F.; ALARCÃO, A. M. (1975) - *Fouilles de Conimbriga, IV. Les sigillées*, Paris: Diffusion E. de Boccard.
- ESCRIVÁ TORRES, V. (1989) - *Cerámica romana de Valentia. La Terra Sigillata Hispánica*, Valencia : Ajuntament de València.
- GENIN, M. (2007) - *La Graufesenque (Millau, Aveyron). Sigillées lisses et autres productions*, vol. II, Pessac : Fédération Aquitania. HAYES, J. W. (1972) - *Late Roman Pottery*, London: British School at Rome.

- LIMANE, H. (2004) - Les sigillées d'importation du I-II siècle après J.-C. du site de Lixus, In AA.VV., *Méditerranée Occidentale Antique: les échanges*. ANSER, Anciennes Routes Maritimes Méditerranéennes, p. 113-149.
- MARTÍNEZ RODRIGUEZ, F. (1987) - *Análisis y personalización de un grupo cerámico de Barniz Rojo de Imitación propio de la Bética Romana Altoimperial*, Unpublished First Degree dissertation. Sevilla.
- MARTÍNEZ RODRIGUEZ, F. (1989) - Las cerámicas béticas de imitación tipo Peñaflor. *Boletín de la Asoc. Española de Amigos de la Arqueología*, 26, p. 60-65.
- MAYET, F. (1978) - Les importations de sigillées à Mérida au Ier siècle de notre ère (sigillées italiennes et gauloises). *Conimbriga*, 17, Coimbra, p. 79-100.
- MAYET, F. (1984) - *Les céramiques sigillées hispaniques : Contribution à l'histoire économique de la Péninsule Ibérique sous l'Empire Romain*, Paris: Diffusion E. de Boccard.
- PASSELAC, M.; VERNHET, A. (1993) - Céramique sigillée sud-galoise. In *Dictionnaire des Céramiques Antiques (VII s. Av. n.è), Méditerranée nord-occidentale*. Lattara 6, p. 569-580.
- REMESAL RODRÍGUEZ, J. (1979) - *La necrópolis Sureste de Baelo*, Excavaciones Arqueológicas en España, 104. Madrid: Ministerio de Cultura.
- REYNOLDS, P. (1995) - *Trade in the Western Mediterranean, AD 400-700: the ceramic evidence*, Oxford: BAR International Series.
- RIBERA I LACOMBA, A. (1981) - Las marcas de terra sigillata de Valentia, *Saguntum*, 16, p. 209-246.
- SÁNCHEZ LAFUENTE, J. (1985) - *Comercio de cerámicas romanas em Valeria*, Cuenca.
- SILLIÈRES, P. (1977) - Belo, important marché espagnol e la céramique de la Graufesenque. *Caesardumum*, 12, p. 436-446
- SILLIÈRES, P.; ROUILLARD, P.; REMESAL RODRÍGUEZ, J. (1979) - Informe de la undécima campaña de Belo, 1976 (Bolonía, Cádiz), *Noticario Arqueológico Hispano*, Madrid, p. 377-422.
- SILVA, P.; BORJA, F.; ZAZO, C.; GOY, J.L.; BAJARDÍ, T.; DE LUQUE, L.; LARIO, J.; DABRIO, C.J. (2005) - Archaeoseismic record at the ancient Roman city of Baelo Claudia (Cádiz, south Spain). *Tectonophysics* 408, p. 129-146.
- VAQUERIZO GIL, D., GARRIGUET MATA, J.A., VARGAS CANTOS, S. (2005) - *La Constancia. Una contribución al conocimiento de la topografía y los usos funerarios en la Colonia Patricia de los siglos iniciales del Imperio*, Córdoba: Univ. de Córdoba, Diput. de Córdoba.
- VERNHET, A. (1976) - Creation flavienne de six services de vaisselle à la Graufesenque. *Figlina*, 1, p. 13-27.
- ZARZALEJOS PRIETO, M. M. (2003) - "Las producciones de TSH precoz. Las sigillatas de imitación de tipo Peñaflor". In BERROCAL, L.; RUIZ, C. eds. *Depósito Alto-Imperial del Castrejón de Capote (Higuera la Real, Badajoz)*, Mérida, p. 133-135.

DIGITAL SOURCES

Samian Research Database, Römisch-Germanisches Zentralmuseum Mainz (RGZM). <http://www.rgzm.de/samian> (accessed 5.3.2019).

The present volume is the outcome of a two-day International Workshop held at the School of Arts and Humanities in Lisbon on the subject “*A terra sigillata sudgálica no Sudoeste da Península Ibérica: circulação e consumo | South Gaulish terra sigillata in Southwest Hispania: circulation and consumption*”, organized by UNIARQ – Centre for Archaeology of the University of Lisbon (28th and 29th of September 2015).

The first day was dedicated to presenting the data about the varying consumption patterns of south Gaulish sigillata in different sites in Lusitania – such as Coimbra, *Ammaia*, Lisbon, Mérida, Tróia and also in sites in the Algarve and Alentejo regions, as well as at Braga (in *Tarraconensis*) and *Baelo Claudia* and Seville, in the former province of *Baetica*. The papers presented provide an up-to-date overview of the import for this tableware both in urban and rural contexts. The second day was a practical session to enable the participants (archaeologists, researchers and students) to learn about how to consult, use and feed information into the “Samian Research database”.

Este volume é o resultado do workshop internacional que teve lugar na Faculdade de Letras de Lisboa intitulado: “*A terra sigillata sudgálica no Sudoeste da Península Ibérica: circulação e consumo | South Gaulish terra sigillata in Southwest Hispania: circulation and consumption*”, organizado pela UNIARQ – Centro de Arqueologia da Universidade de Lisboa (28-29 de Setembro de 2015).

O primeiro dia foi dedicado à apresentação de comunicações sobre os padrões de consumo da *terra sigillata* sudgálica em diferentes sítios da Lusitania - como Coimbra, *Ammaia*, Lisboa, Mérida, Tróia e também de sítios no Algarve e no Alentejo, assim como Braga (na *Tarraconensis*) e *Baelo Claudia* and Sevilha, na antiga província da *Baetica*. O conjunto de estudos apresentados fornece uma panorâmica actualizada da diversidade de importação desta cerâmica de mesa em contextos urbanos e rurais. O segundo dia correspondeu a uma sessão prática permitindo aos participantes (arqueólogos, investigadores e estudantes) aprender como consultar, utilizar e alimentar a base de dados “Samian Research database”.